

FireFX

Atlas 1, 2, 3

Freestanding Fire Range Installation Instructions



IMPORTANT

THE OUTER CASING, FRONT AND GLASS PANEL BECOME EXTREMELY HOT DURING OPERATION AND WILL RESULT IN SERIOUS INJURY AND BURNS IF TOUCHED. IT IS THEREFORE RECOMMENDED THAT A FIRE-GUARD COMPLYING WITH BS 8423 (LATEST EDITION) IS USED IN THE PRESENCE OF YOUNG CHILDREN, THE ELDERLY OR INFIRM.

FUMES RESULTING FROM BLOCKED CHIMNEYS ARE DANGEROUS. KEEP THE CHIMNEY AND FLUE-PIPE CLEAR. SWEEP AND CLEAN ACCORDING TO MANUFACTURER'S INSTRUCTIONS.

All local regulations, including those referring to national and European Standards, need to be complied with when installing the appliance.

Do not attempt to burn rubbish in this appliance. Please read these Instructions carefully before installation or use.

Keep them in a safe place for future reference and when servicing the fire.

The commissioning sheet found on page 3 of these instructions should be completed by the Installer.

PM2085.2.01.26

CONTENTS

Atlas Range

Covering the following models:

Atlas 1	Atlas 2	Atlas 3
732-076	732-105	732-149

Appliance Commissioning Sheet 3

Essential Information 4

Installation Instructions..... 5

Dimensions 7

Distance to Combustibles 9

Distance to Non-Combustibles 11

Pre-installation 12

Installation 16

Commissioning 20

Maintenance and Servicing 21

Servicing 21

Legal Requirements 27

Spare Parts 29

Information Requirement 31

Service Records 32

APPLIANCE COMMISSIONING SHEET

To assist us in any guarantee claim please complete the following information:-

DEALER APPLIANCE WAS PURCHASED FROM:

Name:

Address:

Telephone Number:

ESSENTIAL INFORMATION - MUST BE COMPLETED:

Date Installed:

Model Description:

Serial Number:

INSTALLATION ENGINEER:

Company Name:

Address:

Telephone Number:

COMMISSIONING CHECKS - TO BE COMPLETED AND SIGNED:

Is flue system correct for the appliance:	YES <input type="checkbox"/>	NO <input type="checkbox"/>
Flue swept and soundness test complete:	YES <input type="checkbox"/>	NO <input type="checkbox"/>
Smoke test completed on installed appliance	YES <input type="checkbox"/>	NO <input type="checkbox"/>
Spillage test completed	YES <input type="checkbox"/>	NO <input type="checkbox"/>
Use of appliance and operation of controls explained	YES <input type="checkbox"/>	NO <input type="checkbox"/>
Clearance to combustible materials checked	YES <input type="checkbox"/>	NO <input type="checkbox"/>
Instruction book handed to customer	YES <input type="checkbox"/>	NO <input type="checkbox"/>
CO Alarm Fitted	YES <input type="checkbox"/>	NO <input type="checkbox"/>
Flue draught Reading (Pa)	HOT <input type="text"/>	COLD <input type="text"/>

Signature:

Print Name:

ESSENTIAL INFORMATION

GENERAL	Model:			Atlas 1	Atlas 2	Atlas 3
	Nominal Heat Output	Wood	kW	5	6.2	6.2
	Efficiency	Wood	%	81	82	82
	CO @ 13% O₂	Wood	%	0.1	0.05	0.05
	Weight	Wood	Kg	99	104	111
	Recommended Fuels	Wood	Seasoned Wood (less than 20% moisture content)			

As tested to the requirements of EN 16510 for intermittent operation

FLUES	Flue Outlet Size (Top or Rear Option)	This appliance requires a suitable adapter to fit to a flue larger than 128mm (5").	mm	146	146	146		
			inch	6	6	6		
	Flue/Chimney Size	Without flue liner Round (Diameter)		mm	146	146	146	
				inch	6	6	6	
		Without flue liner system (Square)		mm	135	135	135	
				inch	5 ½	5 ½	5 ½	
				With Liner of Factory made system (diameter) installed in accordance with manufacturers instructions	mm	150	150	150
					inch	6	6	6
	Flue/Chimney minimum height**	All products **must be 4.5m from the hearth to the top of the flue, with no horizontal sections and a maximum of 4 bends. Bends must have angles ≤ 45 degrees from the vertical.	m	4.5	4.5	4.5		
			feet	12	12	12		
	Flue Draught	Min Nominal Max	Pa	10	10	10		
12				12	12			
20				20	20			
Flue Gas Mass Flow	Wood	g/s	4.6	4.7	4.7			
Average Flue Gas Temperature	Wood	°C	265	298	298			

European Min Spec for Chimney Flue - T400 N2 D 3 G50

VENTILATION	A) Traditionally Built Homes		B) Modern Construction Homes			
	<ul style="list-style-type: none"> Where leakage is greater than 5m³/hour/m² Ventilation normally required = 500mm² per kW output over 5kW 		<ul style="list-style-type: none"> Where leakage is less than 5m³/hour/m² Ventilation normally required = 500mm² per kW 			
	A	Additional Ventilation	mm ²	n/a	600	600
			cm ²	n/a	6	6
			in ²	n/a	2.4	2.4
	B	Additional Ventilation	mm ²	2500	3100	3100
			cm ²	25	31	31
			in ²	10	13	13

INSTALLATION

REGISTERED PROFESSIONAL

Before installation and/or use of this appliance please read these instructions fully and carefully to ensure that you have fully understood their requirements.

The appliance must be fitted by a registered installer, or approved by your local building control officer.

STRUCTURAL SUPPORT

If installing on a wooden floor check that the floor joists are strong enough to bear the weight of the insert, chimney and construction parts.

HEARTH

See page 9 for hearth dimensions.

FINAL INSPECTION OF THE INSTALLATION

When it has been installed, the appliance must be commissioned in accordance with standards and practices to ensure full working order and a correct handover given to the customer.

COMBUSTION AIR SUPPLY

When the appliance is installed, it is essential to ensure adequate air is supplied to the room. Air can be provided indirectly via a vent in the outer wall or via a duct from the outside that connects to the sleeve on the rear of the freestanding appliance. The required volume of combustion air is about 20m³/hour.

The outer diameter of the combustion air connection sleeve is 90mm.

If a pipe is longer than 1m, its diameter must be increased to 100mm and a larger wall vent will be required.

In heated spaces, the flue must be insulated to prevent condensation using 30mm mineral wool covered with a vapour barrier. The hole in the wall (or floor) at the exit point must be properly sealed with flue jointing compound.

A flexible pipe to provide external air directly into the appliance is available and must be fitted at the time of installation.

OPTIONAL EXTRAS

EXTERNAL AIR CONNECTION

This appliance can be fitted with an optional kit to help bring air directly into the appliance from outside. For installation and operating procedures see page 19.

APPLIANCE	PART NO.
Atlas 1	998-080
Atlas 2	998-080
Atlas 3	998-080

PARTS IDENTIFIER

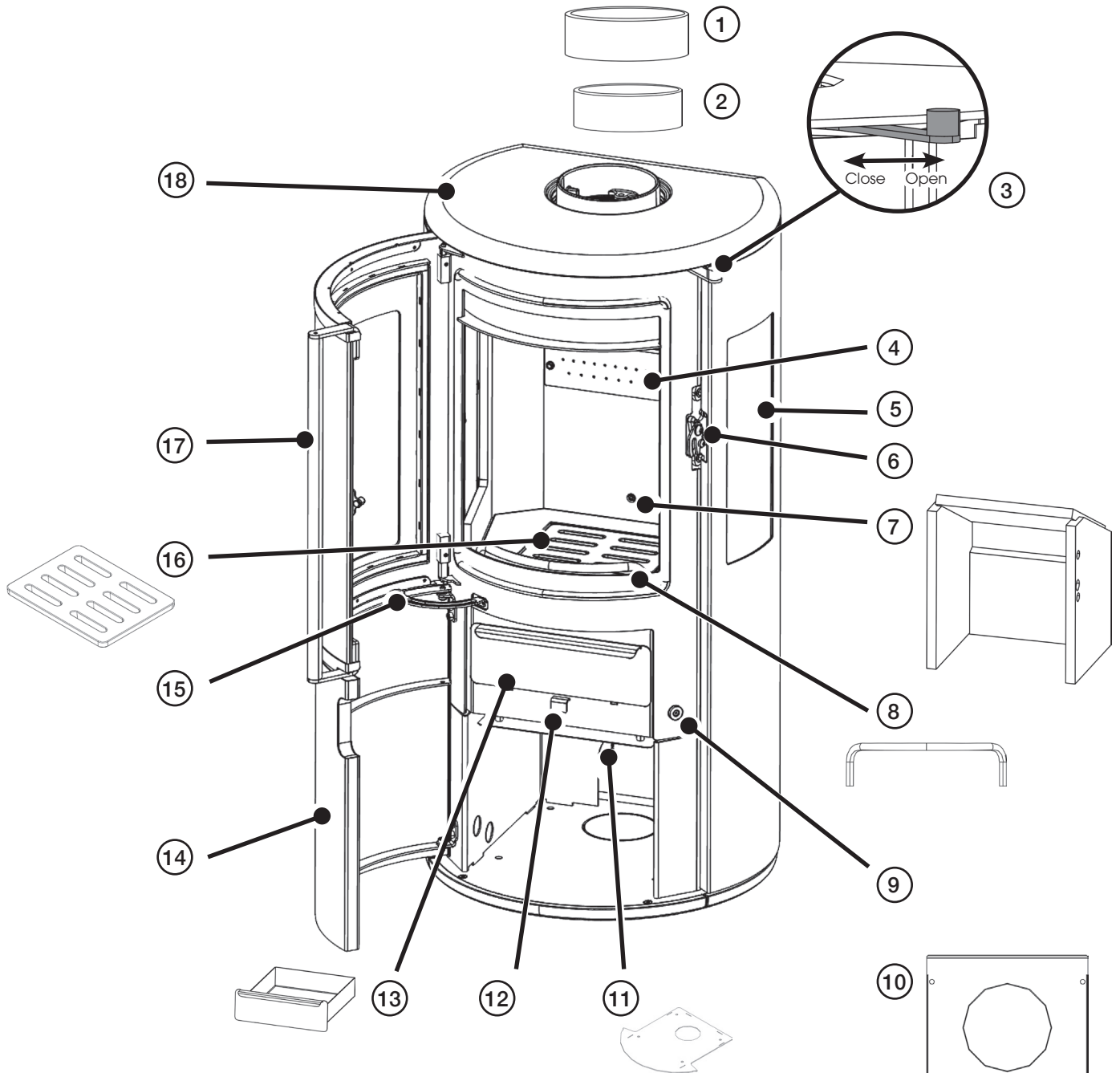

REF.	DESCRIPTION	REF.	DESCRIPTION
1	Flue Adaptor	10	Heat Shield: Rear
2	Flue Collar	11	Heat Shield: Log Store
3	Airwash	12	Primary Air Control
4	Clean Burner Plate	13	Ash Pan
5	Side Window (Atlas 2 and 3)	14	Log Store Door
6	Door Catch	15	Bottom Door Guide
7	Firebrick Assembly	16	Centre Grate
8	Fuel Retainer	17	Door Handle
9	Magnet Closure for Log Store Door	18	Top Plate

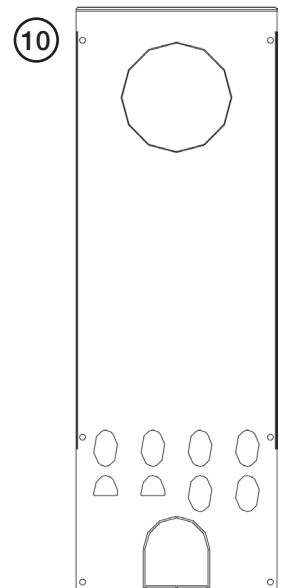

Atlas 2 shown

DIMENSIONS

ATLAS 1

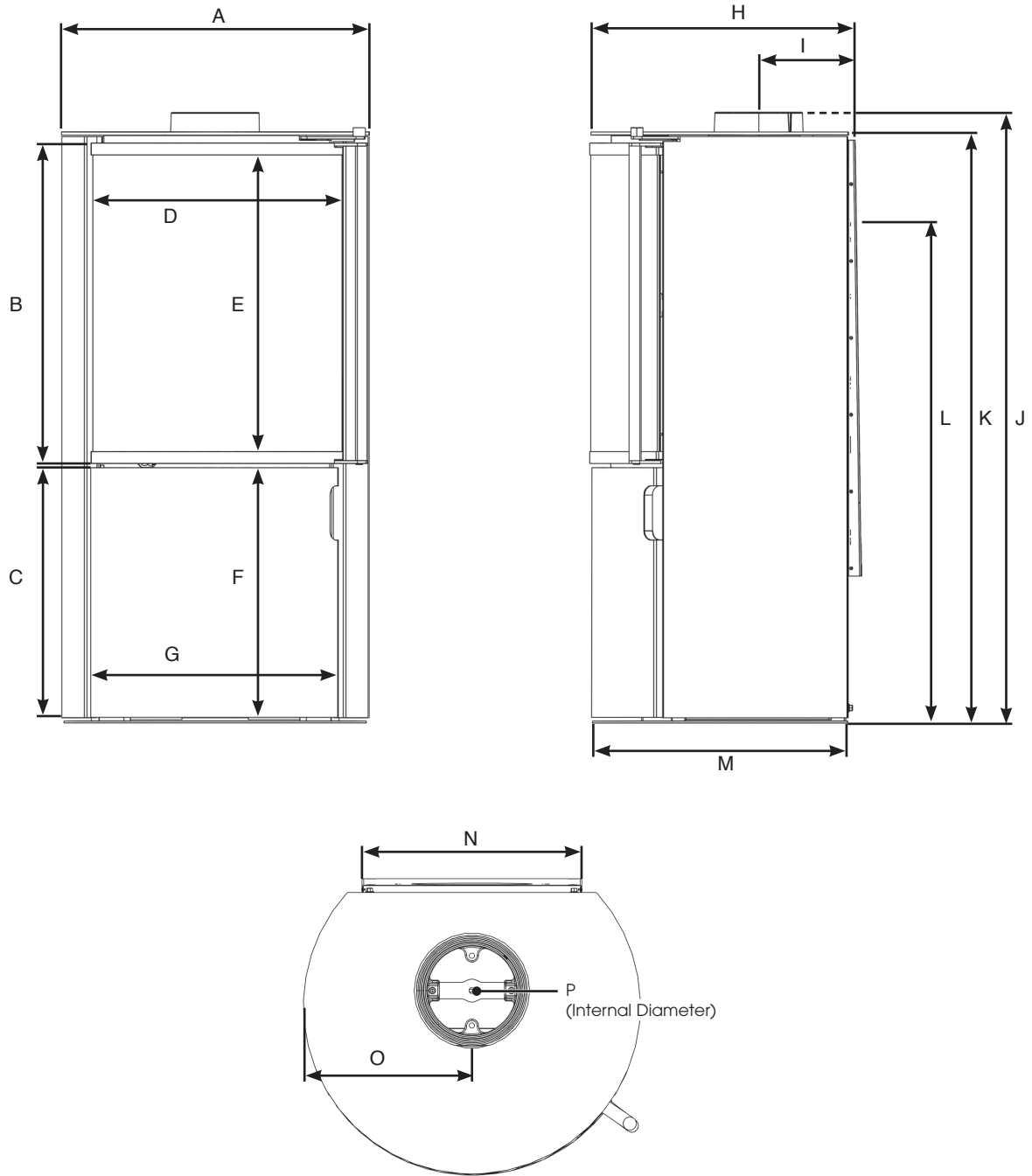

APPLIANCE	A	B	C	D	E	F	G	H	I	J	K	L	M	N	O	P
Atlas 1	510	534	416	414	494	411	416	441	160	1017	984	828	425	333	256	149

All dimensions in mm (25.4 mm = 1")

DIMENSIONS

ATLAS 2 AND 3

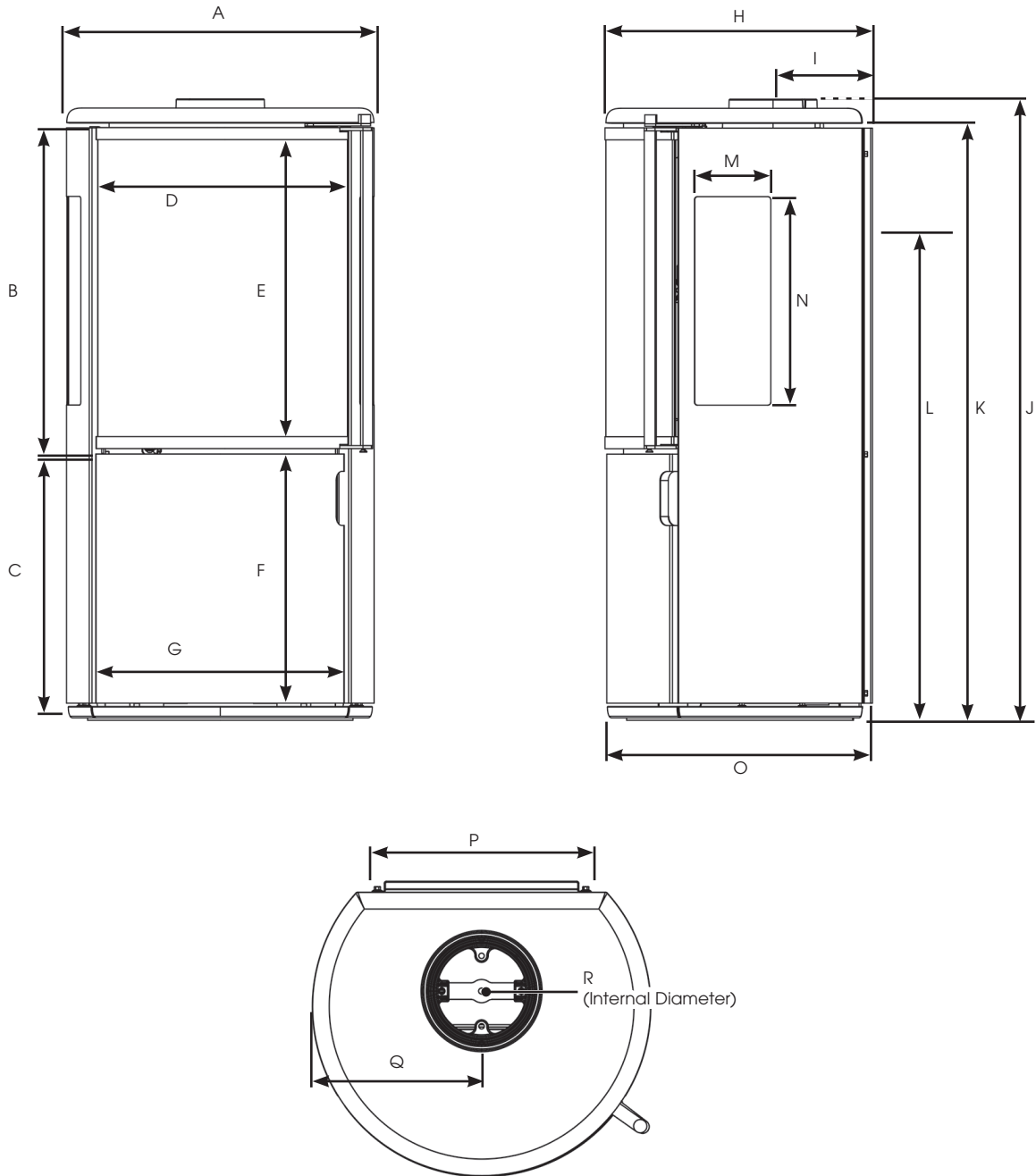

APPLIANCE	A	B	C	D	E	F	G	H	I	J	K	L	M	N	O	P	Q	R
Atlas 2	510	534	415	414	494	411	415	442	165	1034	1019	848	126	347	450	255	293	150
Atlas 3	510	534	541	414	494	411	516	442	175	1135	1119	948	126	347	450	255	293	150

All dimensions in mm (25.4 mm = 1")

MINIMUM CLEARANCE TO COMBUSTIBLE MATERIAL

ENCLOSED SETTING

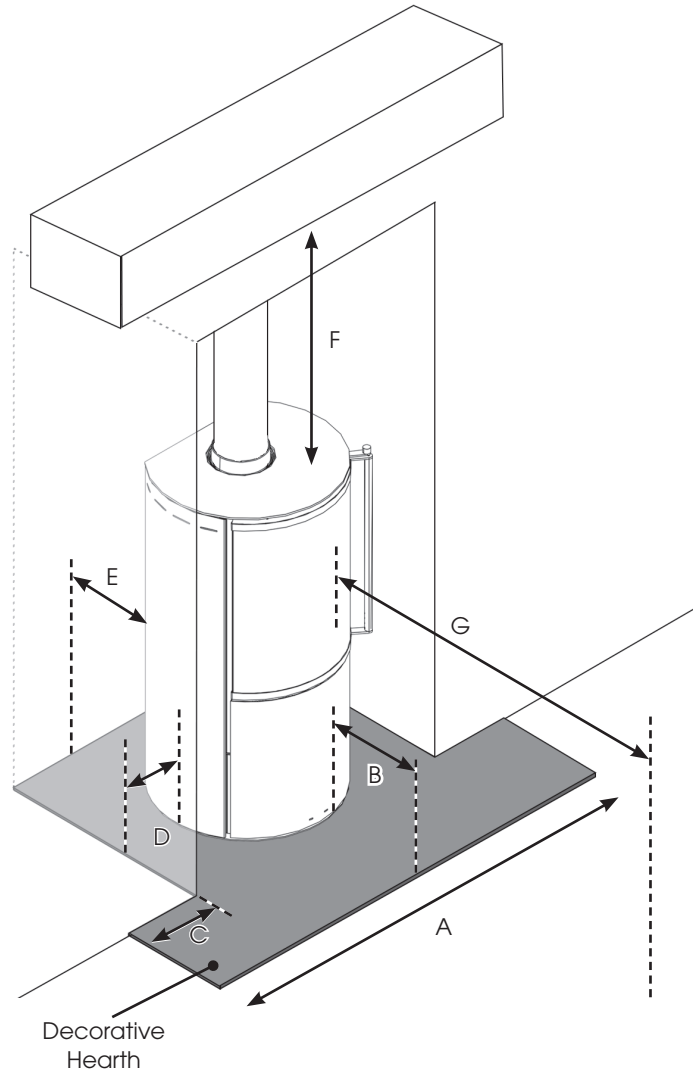

DIMENSION	A	B	C	D	E	F	G	CONSTRUCTIONAL HEARTH
Atlas 1	900	225	150	300	125	450	800	NOT REQUIRED
Atlas 2	1200	225	150	450	180	450	800	NOT REQUIRED
Atlas 3	1200	225	150	450	180	450	800	NOT REQUIRED

All dimensions in mm (25.4 mm = 1")

MINIMUM CLEARANCE TO COMBUSTIBLE MATERIAL

OPEN SETTING

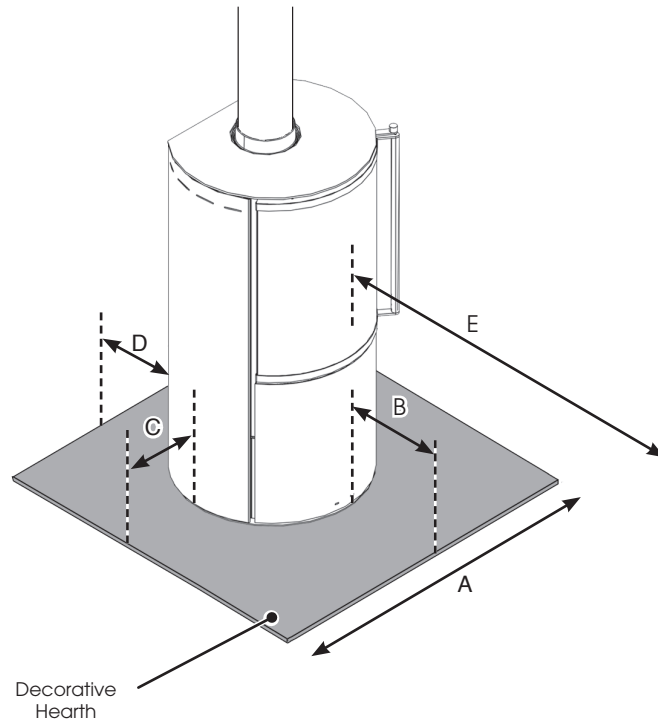

DIMENSION	A	B	C	D	E	CONSTRUCTIONAL HEARTH
Atlas 1	600	225	300	125	800	NOT REQUIRED
Atlas 2	900	225	450	180	800	NOT REQUIRED
Atlas 3	900	225	450	180	800	NOT REQUIRED

All dimensions in mm (25.4 mm = 1")

MINIMUM CLEARANCE TO NON-COMBUSTIBLE MATERIAL

PARALLEL POSITION CLEARANCES

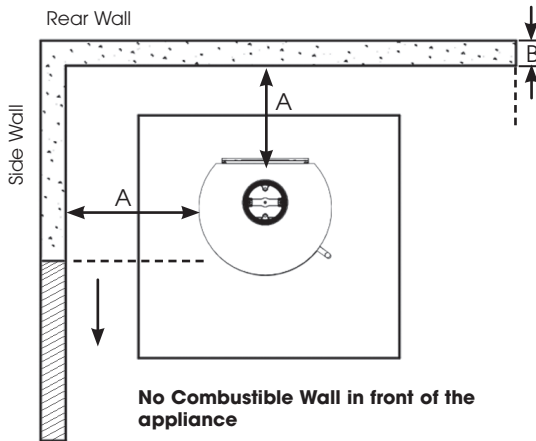

CORNER POSITION CLEARANCES

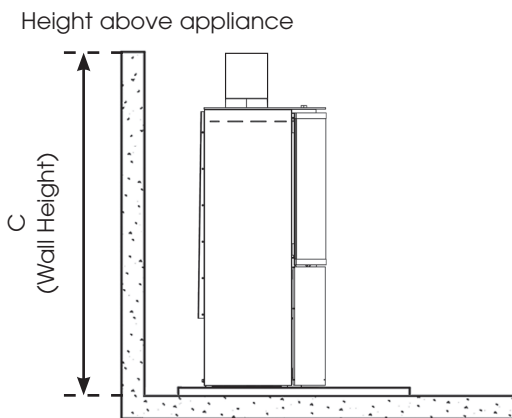
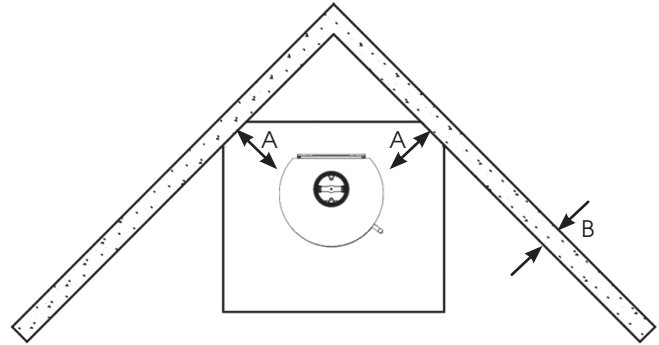

DISTANCE TO NON-COMBUSTIBLE MATERIALS		
Distance of Appliance to Wall (A)	Minimum Thickness of wall (B)	Minimum Height of Wall (C)
50mm - 300mm	75mm	Height of appliance + 300mm OR 1200mm from the hearth (take largest dimension)
300mm+	No requirement	No requirement

HEARTH THICKNESS

These appliances are suitable to stand on a 12mm decorative hearth.

PRE-INSTALLATION

To make the installation of the appliance easier it is best to remove the internal components before installation.

PACKING LIST:

- User and Installation Instructions
- UK/EU Efficiency Label
- Heat Resistant Gloves
- Flue Adaptor



IN ORDER TO SUPPORT THE PARTS AND REDUCE THE LIKELIHOOD OF DAMAGE WE RECOMMEND THAT TWO PEOPLE REMOVE THE DOORS AND GLASS.

WE RECOMMEND THAT DOOR REMOVALS ARE DONE BY A QUALIFIED INSTALLER.

You will need the following to complete the door and glass removals (not included):

- 2.5mm, 3mm and 4mm Allen keys
- A slotted screwdriver
- 8mm and 10mm spanner or socket.

LOG STORE DOOR

①

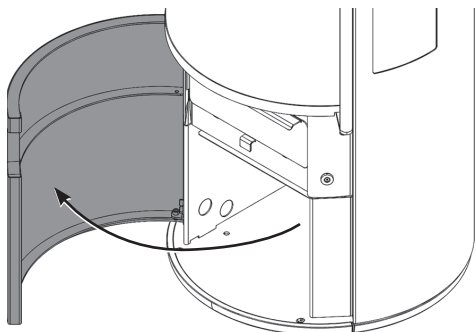

②

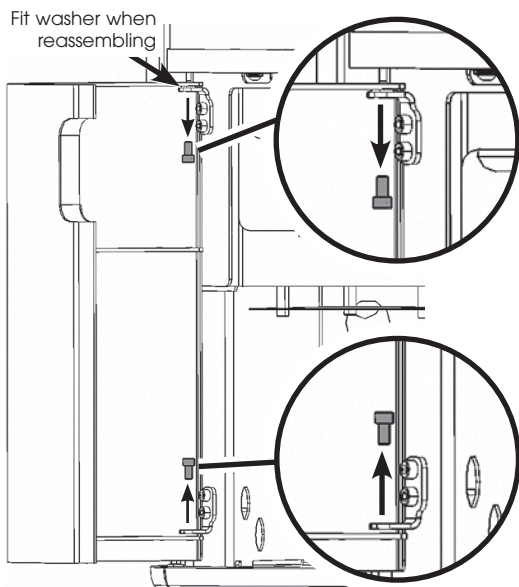

③

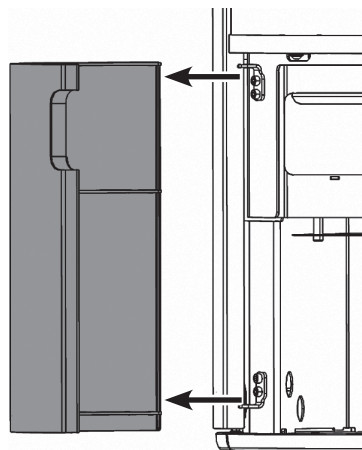

Replace in reverse order.

STOVE DOOR

To remove the stove door, first remove the log store door as well as the top bracket on the log compartment.

①

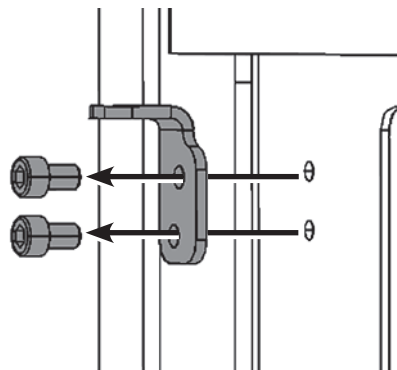

②

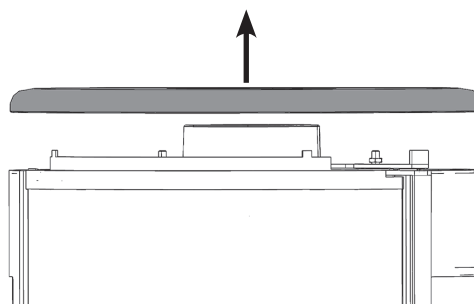

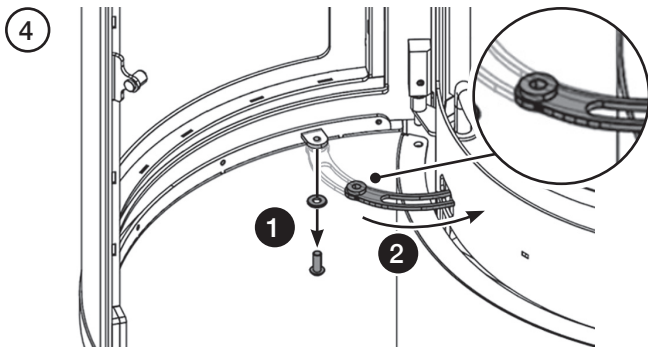
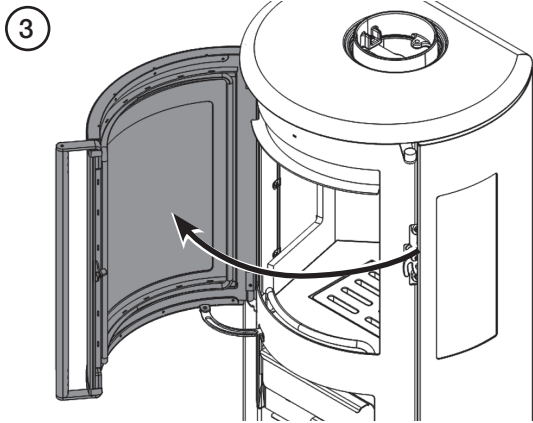

Undo the Allen key bolt and then slide the bottom door guide into the appliance. When refitting the door, take care to also refit the washer on top of the door guide.

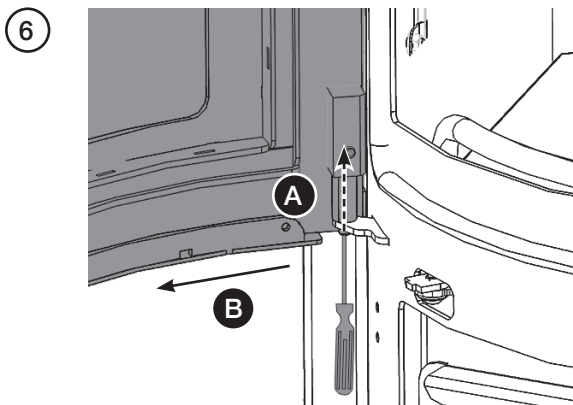

Push the pin up and pull the door out at the bottom so that

the pin is no longer in line with the hole. Remove the screw driver.

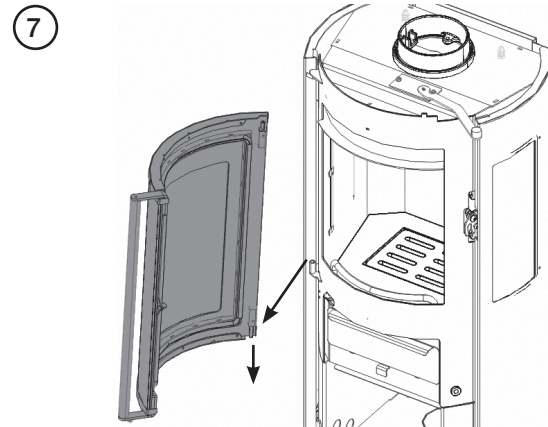

Place the door face down with the glass resting on a soft, flat surface.

To refit the door, see page 25.

REMOVING THE BRICKS

 **BRICKS ARE FRAGILE. TAKE CARE WHEN HANDLING.**

 **IMPORTANT**
The bricks differ between stove models. Ensure that you follow the correct set of instructions.

ATLAS 1

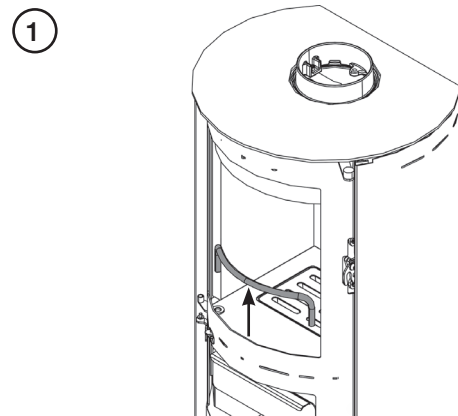

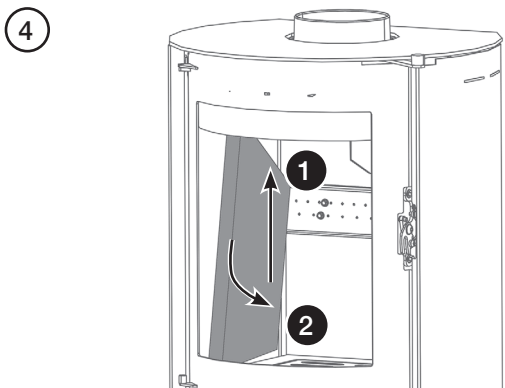
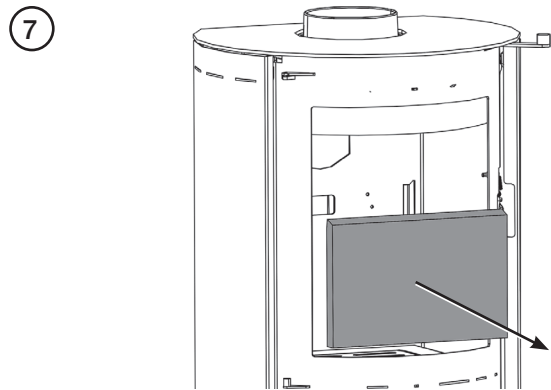
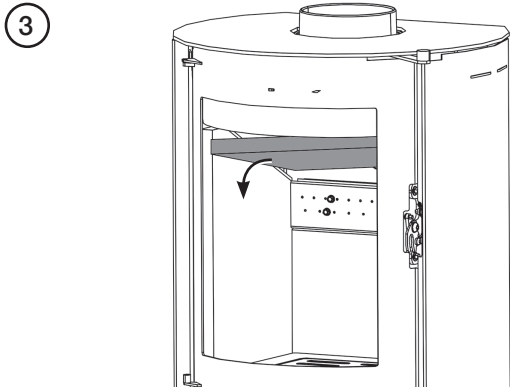
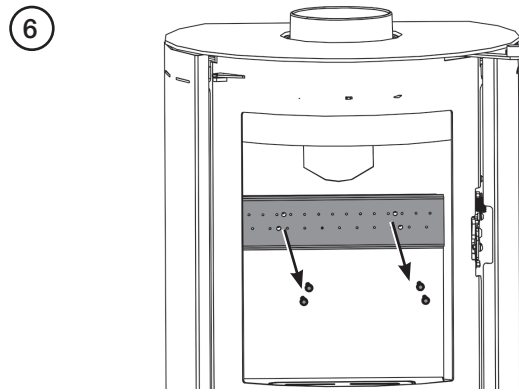
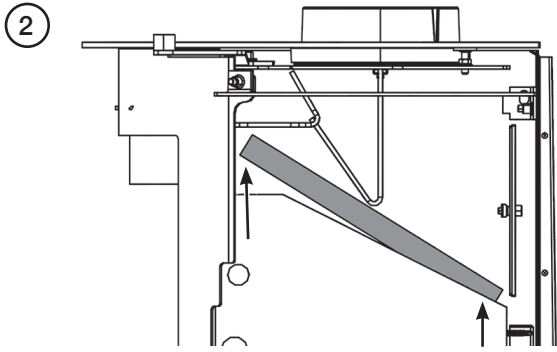

Replace in reverse order.

REMOVING THE BRICKS: ATLAS 2 AND 3

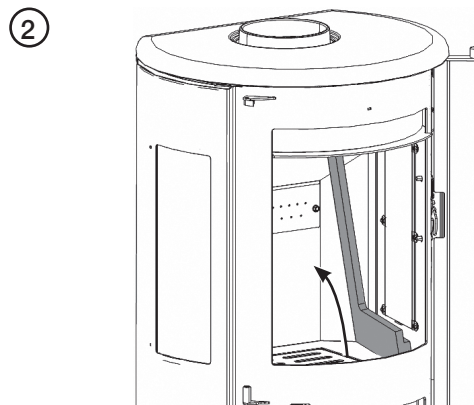
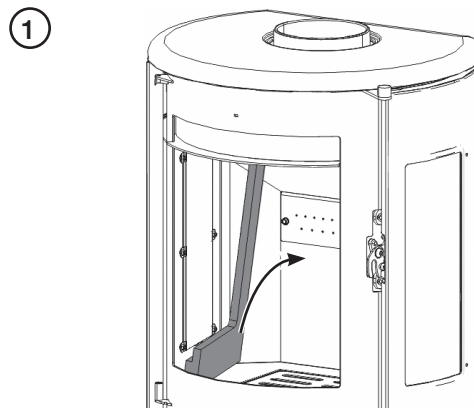
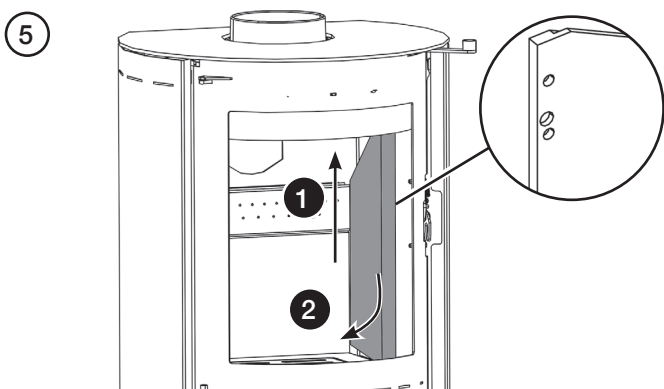

Take note of the holes in the right hand side brick.
Ensure the correct brick is placed back on the correct side.

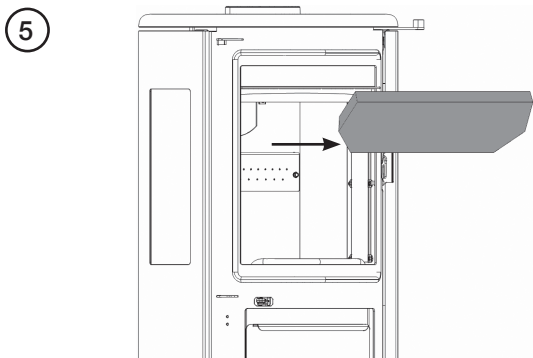
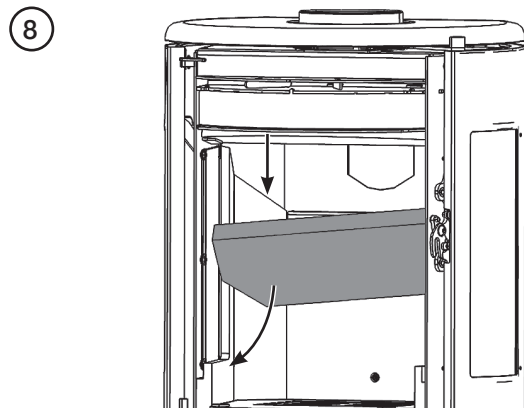
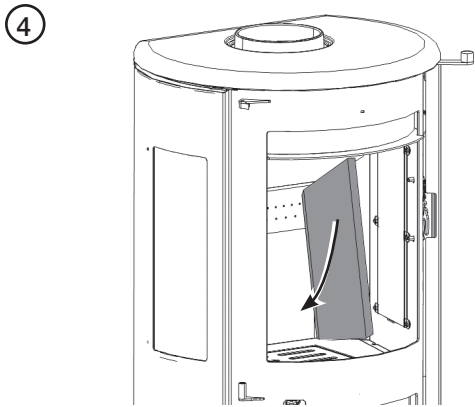
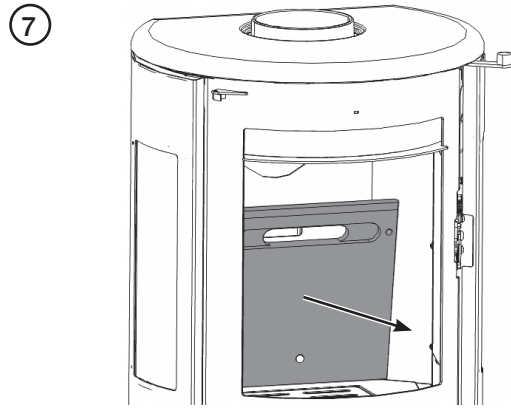
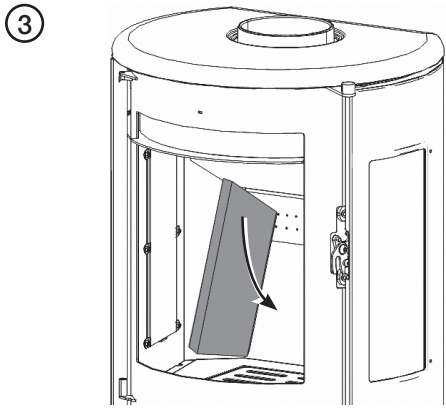

Replace in reverse order.

FIRE GRATE

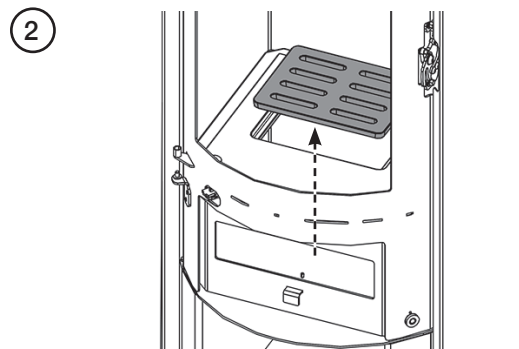
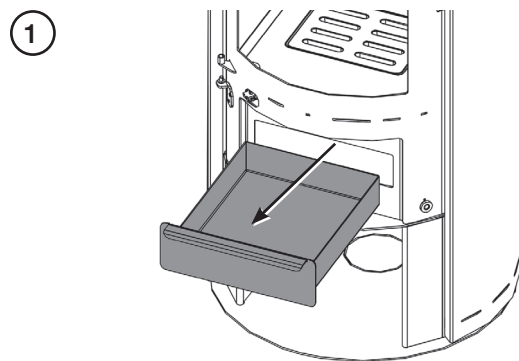
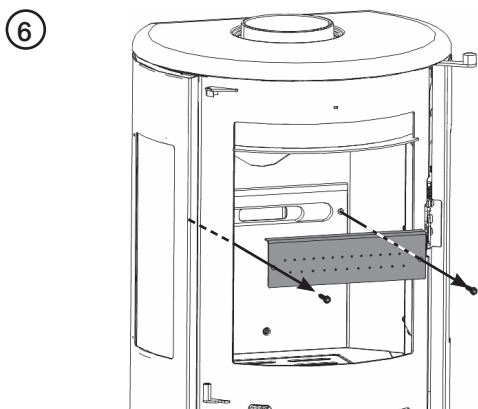

Lift the grate from below, accessed through the ash pan compartment.

INSTALLING THE APPLIANCE

Take care when installing the appliance.
Careless handling and use of tools can damage the finish and/or area.

TOP FLUE

i **IMPORTANT**
The Flue must be installed in accordance with manufacturers instructions.

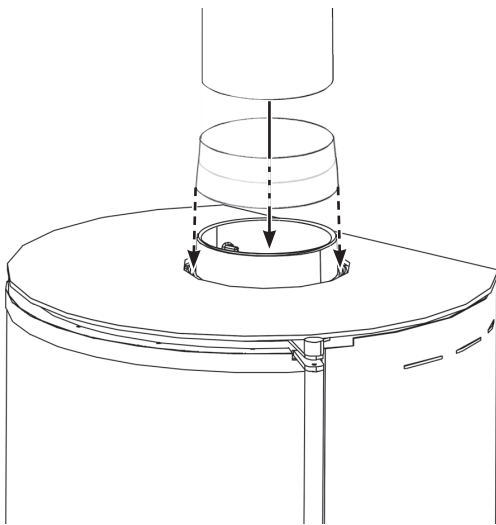

Seal the connection joints.

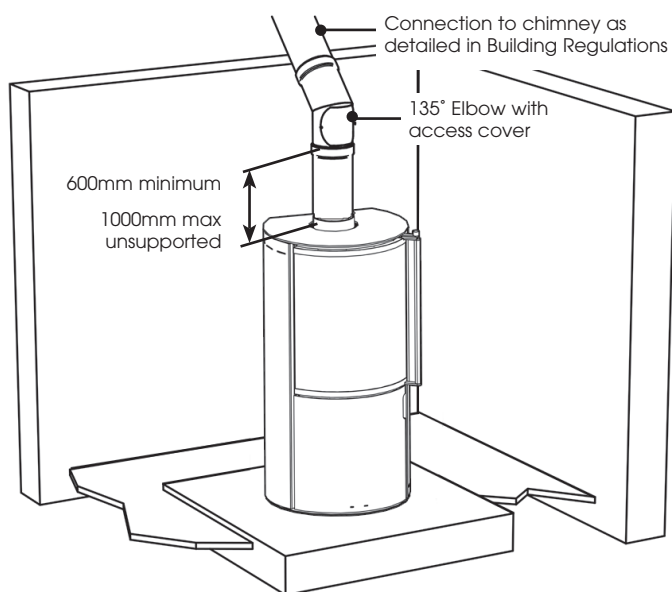

REAR FLUE

i **IMPORTANT**
The appliance is factory set with the blanking plate fitted on the rear outlet.

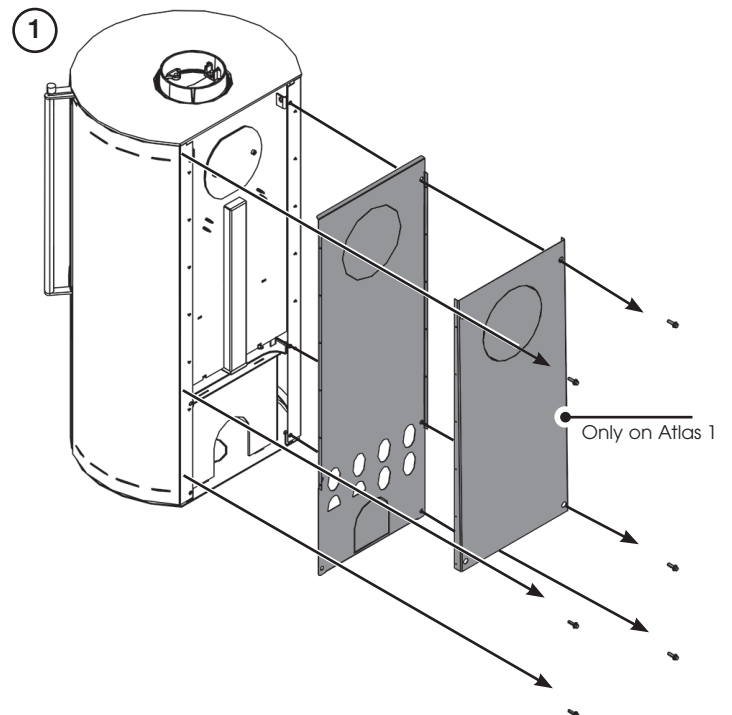
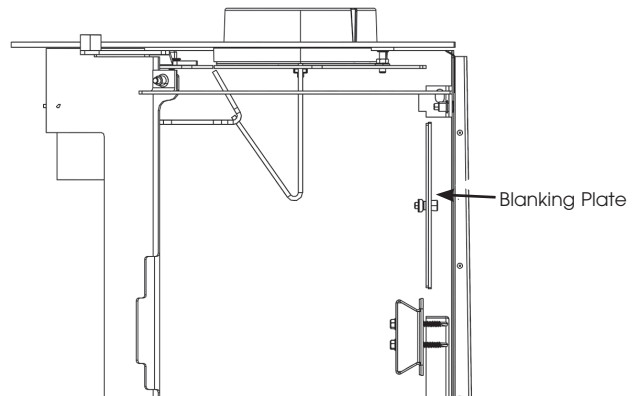

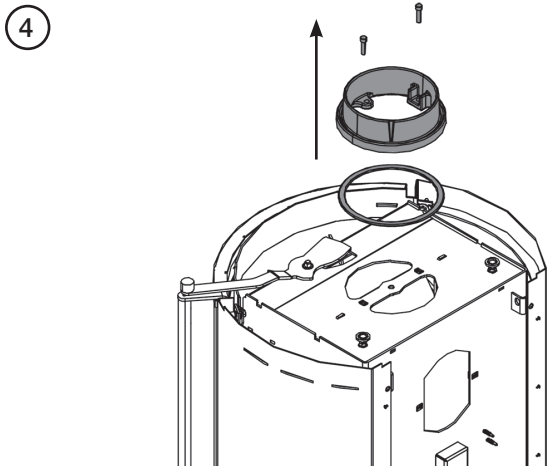
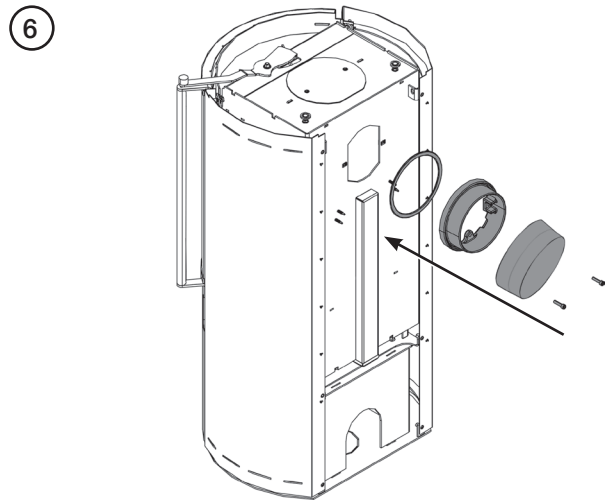
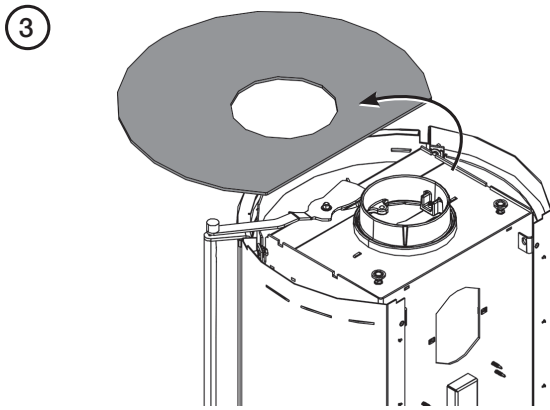
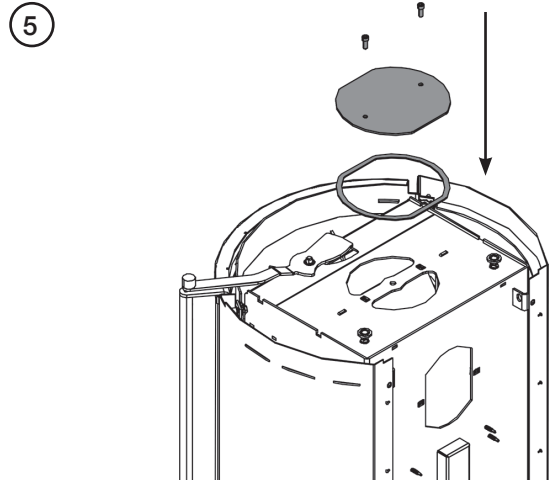
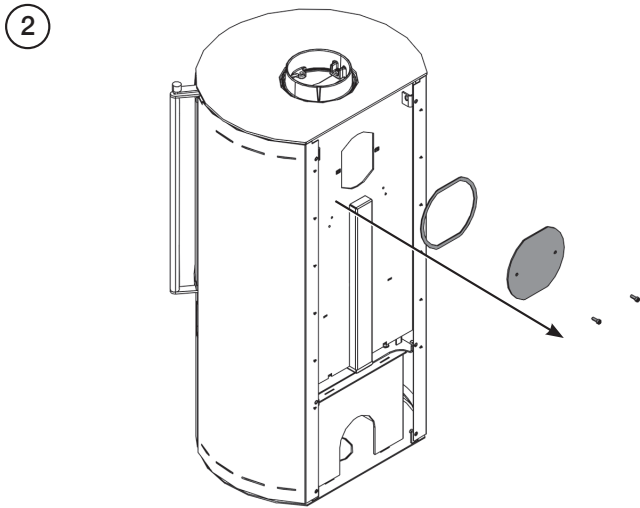

Cut out the discs on the back plates.

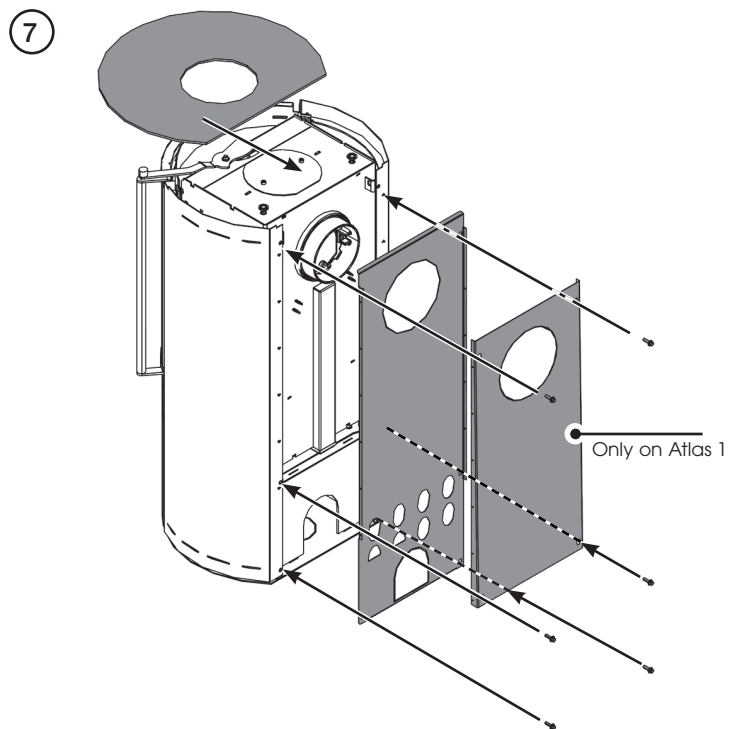

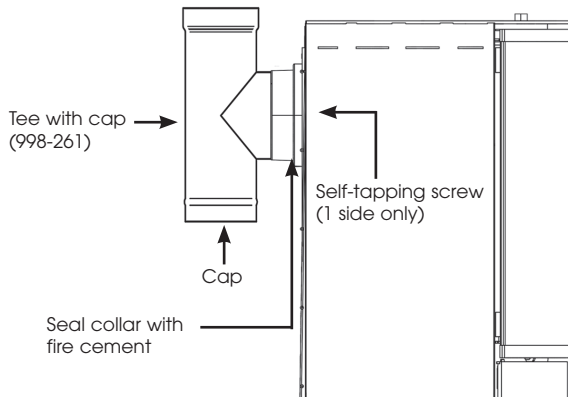

A typical Rear Flue Pipe installation

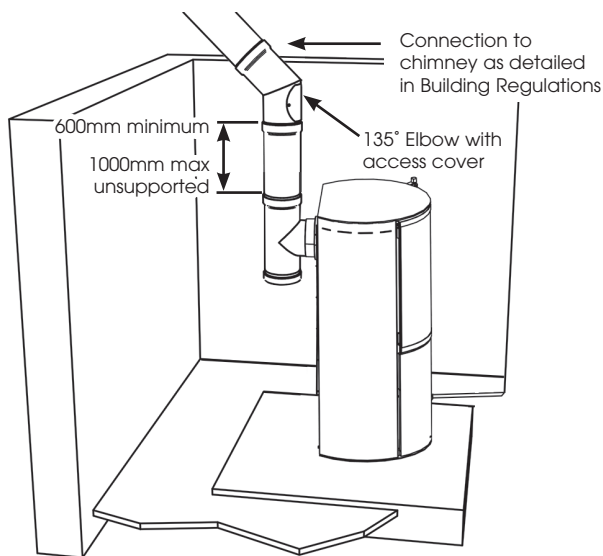

Replace internal components.

CO ALARMS

All open flued appliances can be affected by temporary atmospheric conditions which may allow fumes to enter the house. **Building regulations require that whenever a new or replacement fixed solid fuel or wood/biomass appliance is installed in a dwelling a carbon monoxide alarm, complying with BS EN50291, must be fitted in the same room as the appliance. Further guidance on the installation of the carbon monoxide alarm is available in the latest edition of BS EN50292 and from the alarm manufacturer's instructions.**

Provision of an alarm must not be considered a substitute for either installing the appliance correctly or ensuring regular servicing and maintenance of the appliance and chimney.

EXTERNAL AIR CONNECTION

This appliance can be fitted with an optional kit to help bring air directly into the appliance from outside.

APPLIANCE	PART NO.
Atlas 1	998-080
Atlas 2	998-080
Atlas 3	998-080



WHEN THE OUTSIDE AIR KIT IS NOT FITTED, ENSURE THE STOVE AIR INTAKE IS NOT IMPEDED WHEN FILLING THE LOG STORE.

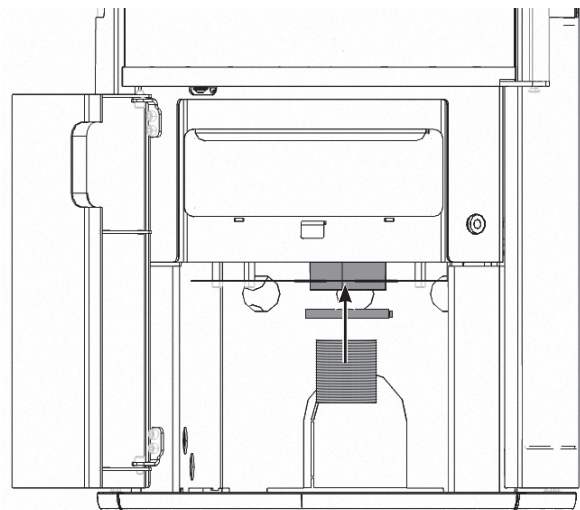

COMMISSIONING

To commission:

- Replace the internal components.
- Check the door alignment and catch operation and adjust if required.
- Check the soundness of door seals, castings and joints.
- Check the operation of the air controls.

Now carry out a final smoke draw test:

- Warm the flue with a blowlamp, or similar, for about 10 minutes.
- Place a smoke pellet on the centre of the grate, with the air controls open.
- Close the door. Smoke should now be drawn up the flue and be seen to exit from the flue terminal.
- Complete test with all doors and windows closed in the room where the appliance is fitted.
- If there are any extractor fans in adjacent rooms the test must be repeated with the fans running on maximum and with interconnecting doors open.
- Check the effect of ceiling fans during the test.

If excessive spillage occurs allow the appliance to cool and re-check the flue system and ventilation.

Finally:

- Explain to the user the correct operation of the appliance, use of the controls and the importance of only using suitable fuels in order to reduce smoke emissions - particularly if they live in a Smoke Control Area.
- Ensure that a CO alarm has been fitted and make the user aware of its operation and importance, referring them to the Warning section of the User Instructions.
- Explain the cleaning and routine maintenance requirements.
- Explain the requirement to use a suitable fireguard when children, elderly or infirm persons are near the appliance.
- Record retailer/supplier and installer details in Appliance Commissioning Checklist.
- Record serial number in Appliance Commissioning Checklist. The serial number is found on the appliance data plate.
- Give this instruction manual to the customer.

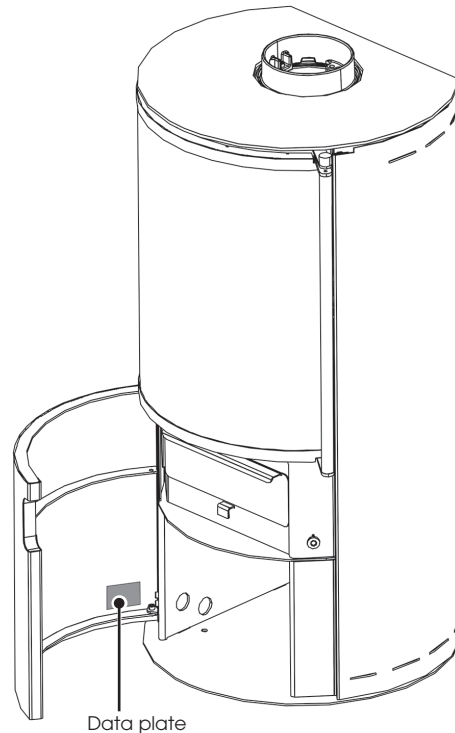

This number is required when ordering spare parts and making warranty claims.

SERVICING

For a complete list of spare parts and accessories contact your Stovax Retailer, visit www.stovaxspares.com or call 01392 474011.

Before the start of the heating season strip, inspect and clean the appliance as detailed:

- Allow appliance to cool.
- Remove all internal parts: baffle, log guard, cast bases and firebricks.
Take care handling firebricks as they can become fragile after a period of use.
- Sweep the appliance at this point if necessary.
- Vacuum clean any remaining ash and debris from the inside of the appliance.
- Check the parts for any damage. Replace any damaged parts using genuine Stovax replacements parts.
- Check and clean the firebricks with a soft brush.

Some surface damage will occur during use. The life of the bricks will depend on the type of fuels burnt and the level of use.

Replace damaged bricks as soon as possible.

- Re-fit cleaned internal parts.

— Use Stovax Glass Cleaner.

Do not use abrasive cleaners to remove tar or soot deposits from the glass.

- Fit new door rope seal.
- Lightly oil the door catch mechanism and hinge pins.
Avoid getting oil onto the door seals and glass.
- To refresh painted finishes a touch up spray is available.
Contact your Stovax retailer quoting the serial number found on the appliance data badge.

Use genuine Stovax replacement parts to keep the appliance in safe, efficient working order. This is a list of the maintenance products that may need be required:

Products to assist in the cleaning and maintenance of your Futura are available online at www.stovax.com or from your local Stovax dealer which, along with regular maintenance and use of correct fuels, will keep the appliance in the best possible condition.

For more information about the Stovax Group products please visit our web site at www.stovax.com

Burn at a low temperature for the first day of use after any maintenance. This allows the seals, fixing glues and paint to fully cure.

During this time the appliance may give off some unpleasant odours.

Keep the room well ventilated to avoid a build-up of fumes.

Your Stovax dealer can carry out service and maintenance.

SERVICING AND SUPPORT



To keep your appliance looking and performing at its best, it must be serviced annually. This service must be undertaken by a suitably qualified individual and your retailer can organise this for you. Alternatively, Stovax offer a manufacturers premium service with our friendly team of qualified engineers which can be booked at www.stovax.com/support

TASK	PRODUCT NAME	NO.
Preventing build-up of creosote in flue	Protector (12 sachets)	7002-1
	Protector (1kg tub)	7025-1
Re-painting	Touch Up Paint (400ml aerosol)	VD-361
Protecting your hands	Heat resistant gloves	4008
Thermic seal glue	(50ml bottle)	5037-1
Cleaning Glass	Stovax Glass Cleaner	4103-1

CLEANING THE FLUE

On Atlas 2 and 3, the pipe can be swept through the access hatch in the baffle, which can be opened by removing the four bolts. Atlas 1 doesn't have an access hatch and can just be swept.

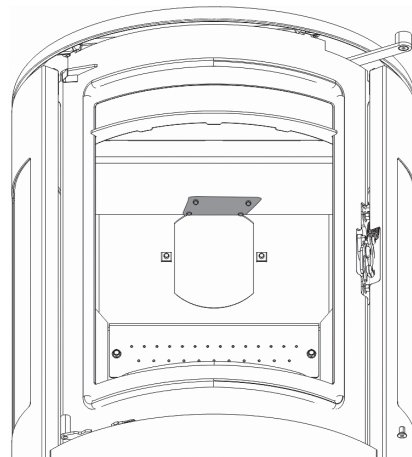

REMOVING A SIDE PANEL

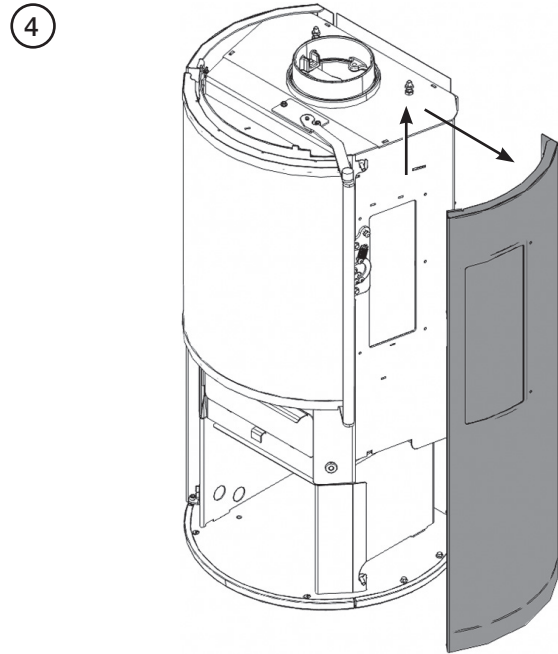
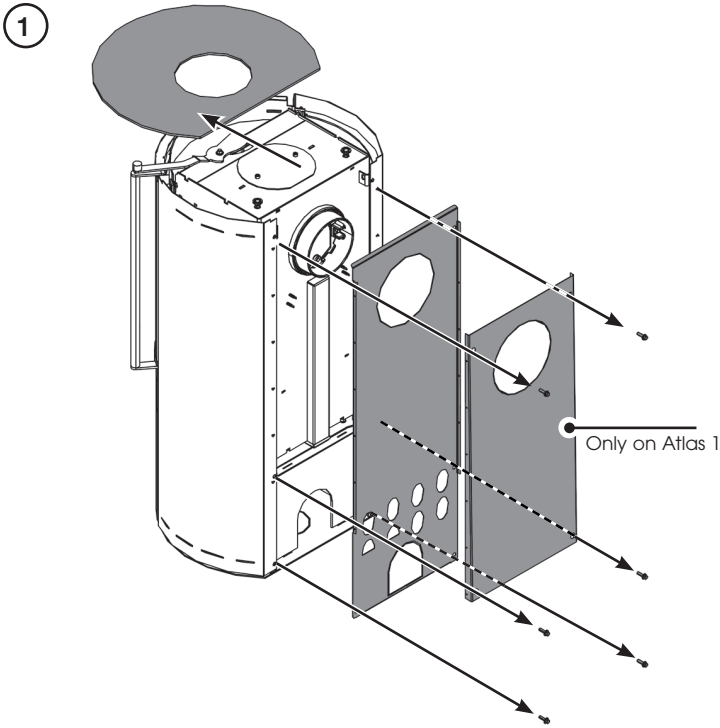

Lay the panel face down on a soft, flat surface.
Replace in reverse order.

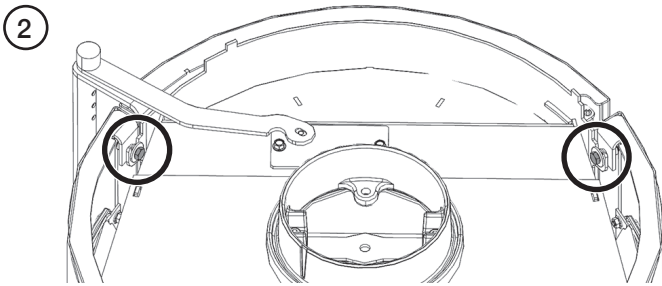

Loosen the bolt for the relevant side panel.

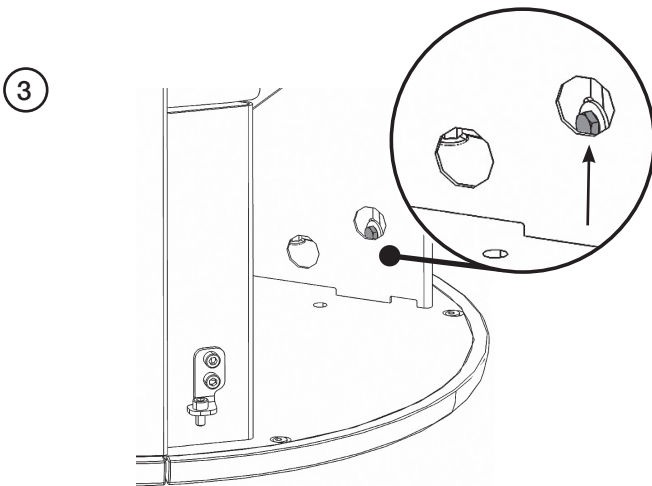

Using a socket spanner, loosen the bottom bolt that is accessed through the port holes inside the log store.

REPLACING GLASS



In order to support the parts and reduce the likelihood of damage, we recommend that two people remove the doors and glass.



USING THE APPLIANCE WITH A DAMAGED DOOR GLASS COULD CAUSE DANGEROUS FUMES TO ENTER THE ROOM, OR THE APPLIANCE TO OVER-FIRE, RESULTING IN DAMAGE.

DOOR GLASS

Remove the door (See page 12).
Lay the door face down on a soft, flat surface to protect the paintwork and glass.

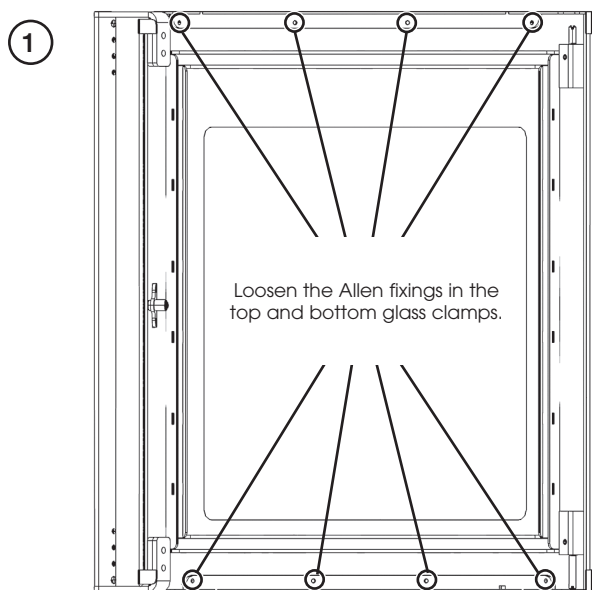

The glass clamp Allen fixings are different lengths.

We recommend leaving the fixings in their holes after loosening them to facilitate an easier reinstallation.

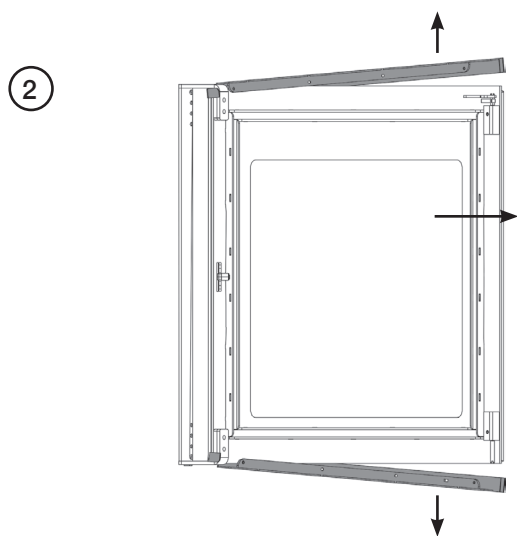

Replace the glass in reverse order.
Ensure that the shaded areas cover the window opening on the steel section of the door.

Dispose of the old glass safely.

INNER GLASS

Only applicable to Atlas 2 and 3.

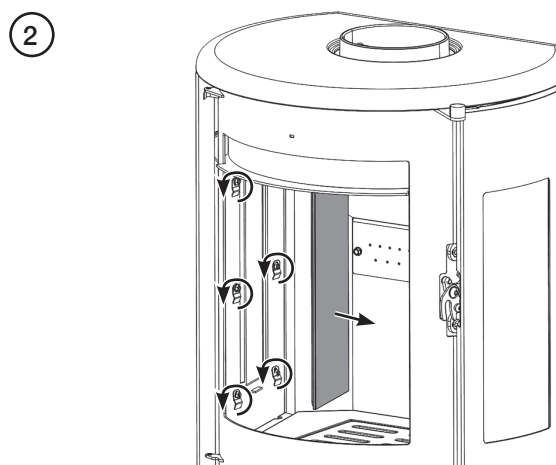
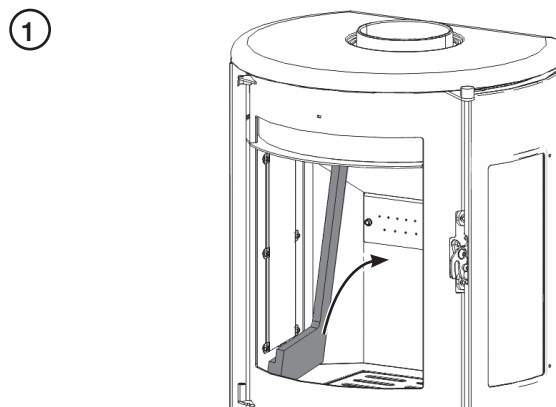

Loosen the six bolts. While supporting the glass pane, rotate the clamps and remove the pane.

Replace in reverse order.

EXTERNAL / PANEL GLASS

Only on Atlas 2 and 3.

Remove the side panel (see page 21) and lay it glass face down on a soft, flat surface.

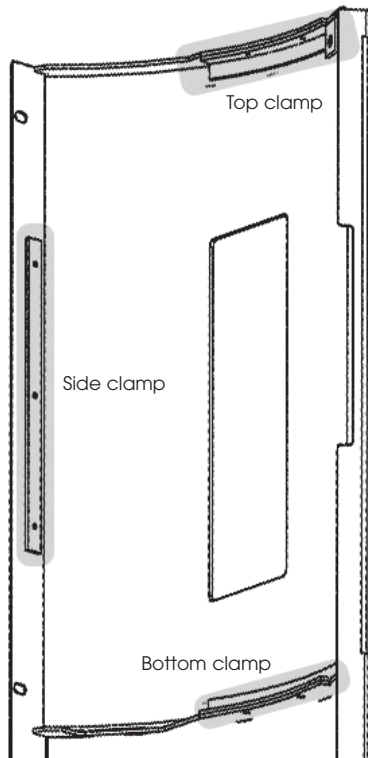

Unscrew the three glass clamps and remove them.

Lift the glass edge next to the side clamp and slide the glass out sideways and up, following its natural curve.

Replace the glass in reverse order and then replace the panel by following the instructions below in reverse

DOOR ROPE SEAL

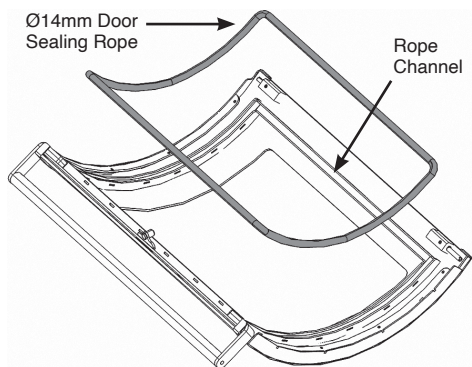

Remove the old rope and scrape old glue from the locating groove.

Clean the locating groove with a clean, dry cloth to remove all old dust and debris.

Squeeze a generous bead of fresh Stovax Thermic Seal glue into the rope locating groove.

Press the new Stovax rope into the locating groove.

DOOR CATCH

If the closing mechanism snaps in by accident, insert a screwdriver into the roller slot and flip it out.



ACCESSING THE DOOR CATCH ATLAS 1

1

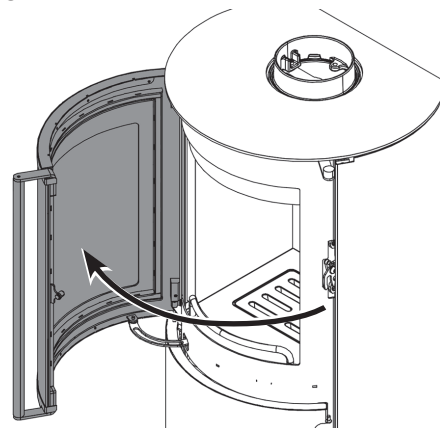

2

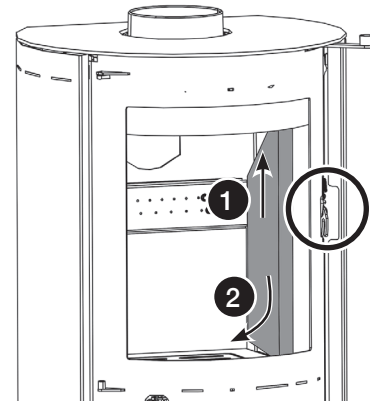

ATLAS 2 AND 3

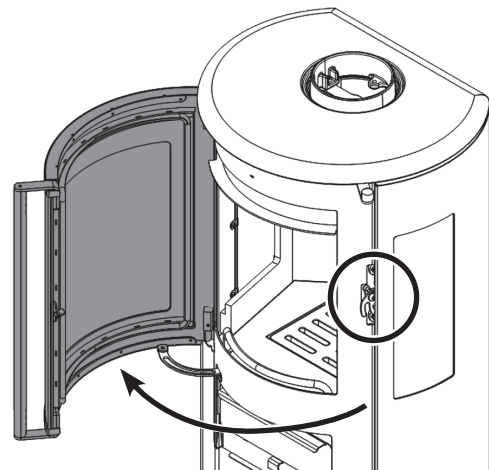

REPLACING THE DOOR



IN ORDER TO SUPPORT THE PARTS AND REDUCE THE LIKELIHOOD OF DAMAGE WE RECOMMEND THAT TWO PEOPLE REMOVE THE DOORS AND GLASS.

WE RECOMMEND THAT DOOR REMOVALS ARE DONE BY A QUALIFIED INSTALLER.

1

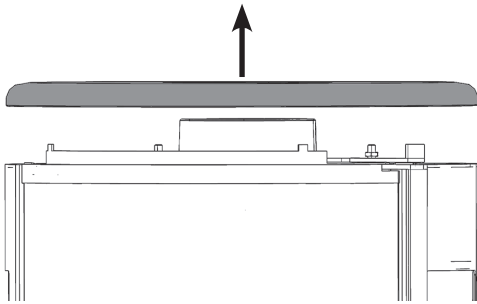

2

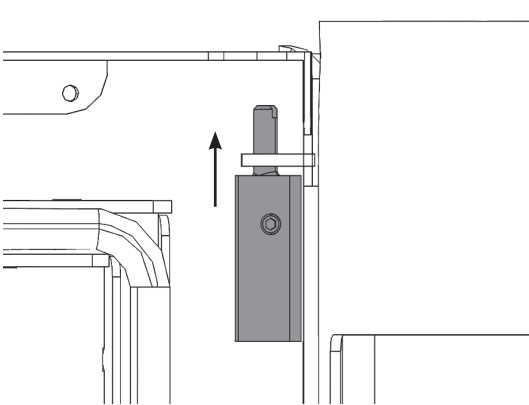

3

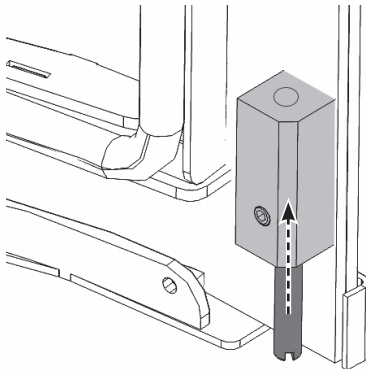

Make sure that the bottom hinge pin is fitted and free to move vertically.

4

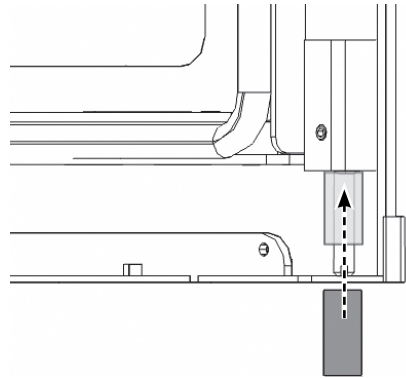

5

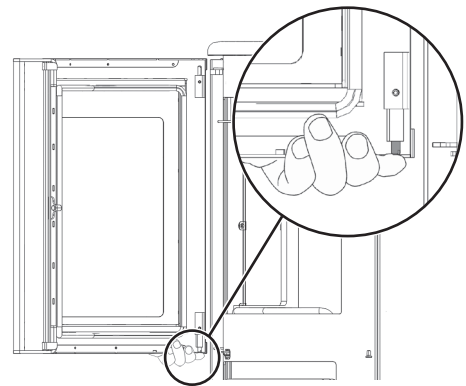

Hold the door vertically.
Keep a finger under the pin to prevent it from falling out.

6

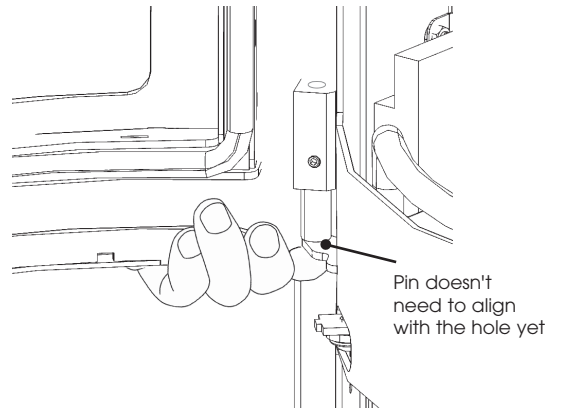

7

A

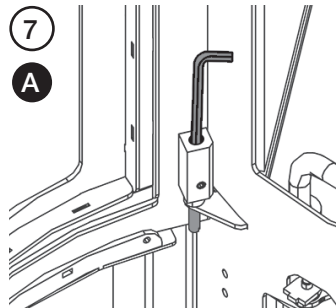

8

B

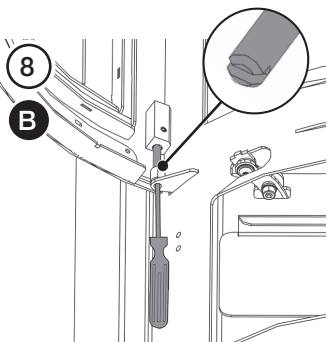

To locate the pin in the hole, either:
— A (recommended): Push the pin through the hinge

bracket hole with an Allen key or similar. Move the door to align the pin and hole;

— B: Use a slotted screwdriver from below the hole to nudge the pin into place.

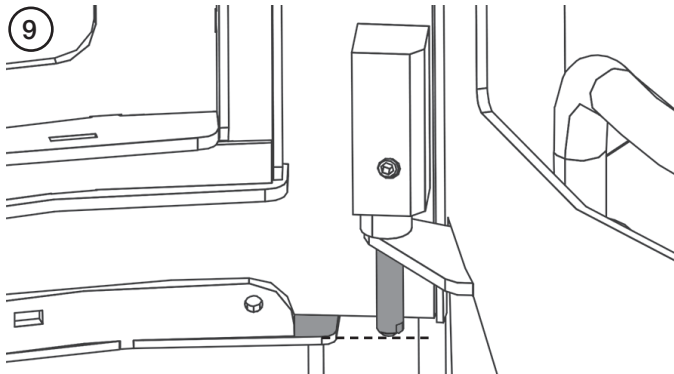

The correct pin position is in line with the bottom of the door.

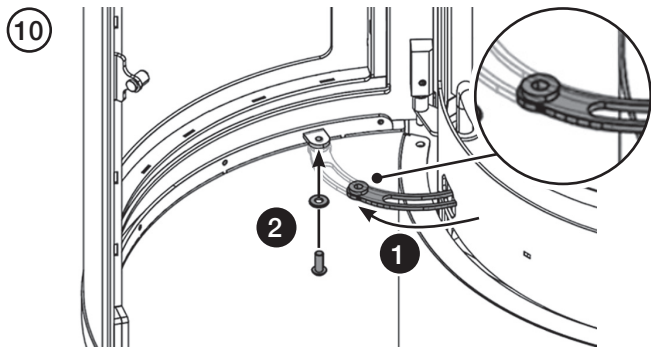

Slide the bottom door guide out of the appliance to attach to the door. Take care to refit the washer between the door fitting and the guide, and then refit the Allen key bolt and washer from below the door guide.

Replace the top plate.

REPLACING THE DOOR HANDLE

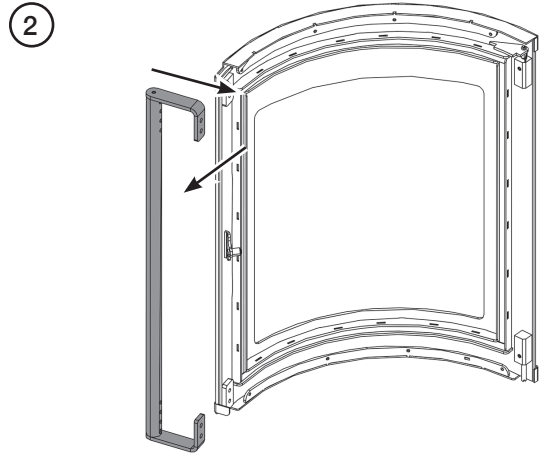
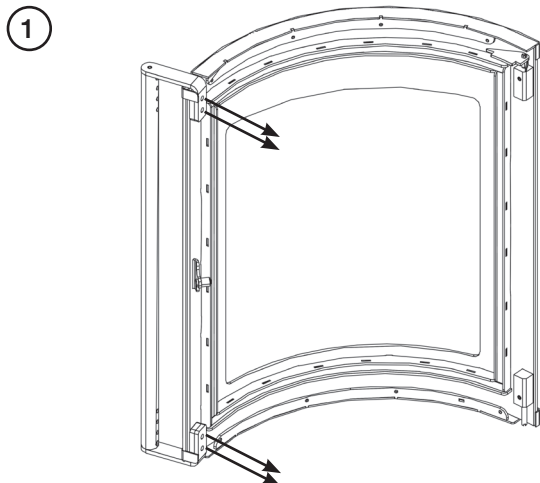

Replace in reverse order.

DOOR ALIGNMENT

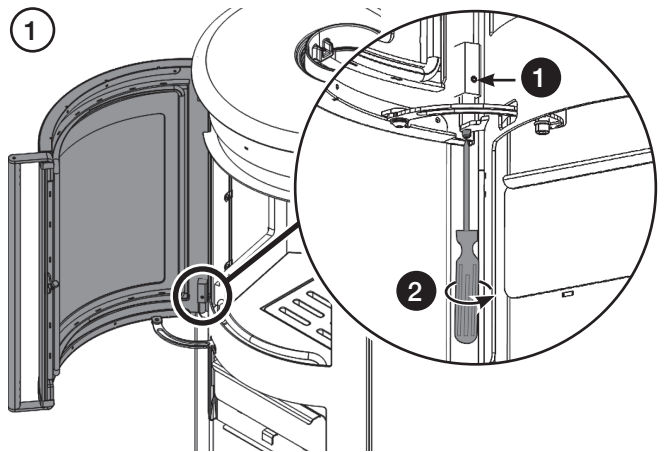

Loosen the Allen key bolt and rotate the hinge pin.

Once the correct alignment has been achieved (in line with the bottom of the door), tighten the Allen key bolt.

FINAL CHECKS

Following these adjustments check that the door:

- Passes the paper sealing test.
- Aligns with the sides and top of the appliance.

LEGAL REQUIREMENTS

Before installation and/or use of this appliance please read these instructions carefully to ensure that all requirements are fully understood.

The appliance must be fitted by a registered installer, or approved by your local building control officer.

It is very important to understand the requirements of the national Building Regulations and standards, along with any local regulations and working practices that may apply. Should any conflict occur between these instructions and these regulations then the regulations must apply.

Your local Building Control Office can advise regarding the requirements of the regulations.

Works must be carried out with care to meet the requirements of Health and Safety and comply with the Health and Safety rules, and any new regulations introduced during the lifetime of these instructions. Particular attention should be drawn to:

- **Handling:** The appliance is heavy. Adequate facilities must be available for loading, unloading and on site handling.
- **Fire Cement:** Some fire cement is caustic and must not come into contact with the skin. Protective gloves must be worn. Wash hands thoroughly with plenty of water after contact with skin.
- **Asbestos:** This appliance contains no asbestos. If there is the possibility of disturbing any asbestos in the course of installation seek specialist guidance and use appropriate equipment.
- **Metal Parts:** Take care when installing or servicing the stove to avoid personal injury.

A faulty installation can cause danger to the inhabitants and structure of the building.

For users of this appliance:

Your building insurance company may require you to inform them that a new heating appliance has been installed on your property. Check that your cover is still valid after installing the appliance.

FLUE OR CHIMNEY

The flue or chimney system must be in good condition. It must be inspected by a competent person and passed for use with the appliance before installation.

Products of combustion entering the room can cause serious health risks.

The following must be checked:

- The construction of the masonry chimneys, flue block chimneys and connecting flue pipe system must meet the requirements of the Building Regulations.
- If it is necessary to fit a register plate it must conform to the Building Regulations.
- The minimum height of the flue or chimney must be 4.5m from the hearth to the top of the flue, with no horizontal

sections and a maximum of 4 bends. Bends must have angles of less than 45 degrees from the vertical.

- There should be at least 600mm of vertical flue pipe above the appliance before any bends are introduced.
- Ensure the connecting flue pipe is kept a suitable distance from any combustible material and does not form part of the supporting structure of the building.
- The installer must ensure the flue pipe diameter is not less than the diameter of the outlet of the appliance and does not narrow to less than the size of the outlet at any point in the system.
- Make provision to remove the appliance without the need to dismantle the chimney.
- Any existing flue must be confirmed as suitable for the new intended use as defined in the Building Regulations.
- The flue or chimney system must be inspected and swept to confirm the system is structurally sound and free from obstructions.
- If the chimney is believed to have previously served an open fire it must be swept a second time within a month of regular use after installation to clear any soot falls that may have occurred due to difference in combustion levels.
- The flue exit from the building must comply with local building control rules.
- Chimney heights and/or separations may need to be increased in particular cases where wind exposure, surrounding tall buildings, high trees or high ground could have adverse effects on flue draught.
- Do not connect or share the flue or chimney system with another heating appliance.

Do not connect to systems containing large voids or spaces over 230mm square.

Suitable access must be provided to enable the collection and removal of debris.

The flue must be swept and inspected when the appliance is installed.

FLUE DRAUGHT

The flue draught must be checked with all windows and doors closed and any extraction fans in this, or adjoining rooms, running at maximum speed (see Installation Checklist for ventilation requirements).

TWIN WALL FLUE SYSTEM

If this appliance is to be used in conjunction with a twin wall flue system then Stovax recommend the use of their Professional XQ range. Details of this product are available from your Stovax retailer.

VENTILATION

Many older buildings are sufficiently ventilated by natural leakage of air to provide suitable air supply for an appliance of 5kW output or less.

Modern building techniques have reduced the amount of air that leaks in or out of a house. A modern construction with an air tightness of less than 5m³ per hour per m² requires an air vent for **ALL** solid fuel appliances including those with a rated heat output of less than 5kW.

NOTE: The air leakage of a modern house is tested at the completion of construction and a certificate issued confirming this.

This appliance requires a constant supply of air to maintain proper combustion and effective flue performance.

An inadequate air supply can result in poor combustion and smoke entering the room, which is potentially dangerous.

This supply of air can come from either:

- Purpose provided ventilation.
- Some Stovax appliances can also be fitted with an optional outdoor air kit which allows air to be drawn in from the outside.

The amount of air required must comply with local building regulations and the rules in force.

If vents open into adjoining rooms or spaces there must be an air vent of at least the same size direct to the outside.

Site the vents where cold draught is unlikely to cause discomfort. This can be avoided by placing vents near ceilings or close to the appliance (See diagram).

Extractor fans, cooker hoods and other heating devices placed in the same room or space as the appliance may cause problems. Extra ventilation must be installed as per each appliance's requirements.

The appliance shall not be installed with ventilating systems which have pressure below -15Pa.

Increase air supply provisions where a room contains multiple appliances.

If any checks reveal problems do not proceed with the fitting of the appliance until they have been rectified.

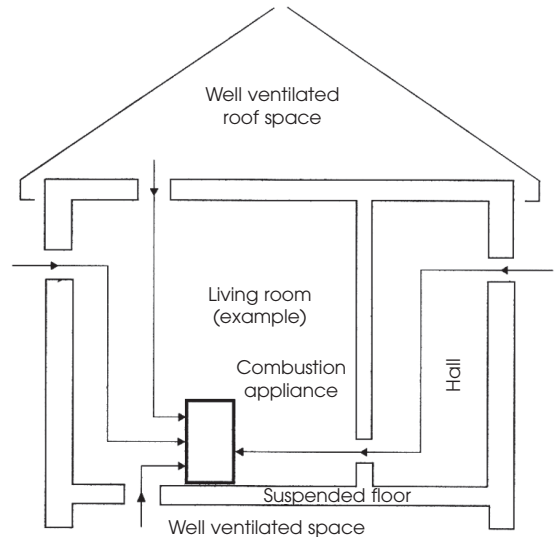

BUILDERS OPENING

Many fireplace openings have a supporting lintel. Remove the covering plaster to identify its position before starting any constructive work. Do not remove constructional lintels without making provision to support the remaining structure of the building. The appliance must not form any part of the supporting structure.

The chimney/flue must have a sealed connection to the appliance flue spigot.

The structure of the builders opening will reach high temperatures. Use insulating blockwork to reduce the heat transfer to the external walls.

Take care when finishing the chimney breast and surrounding area. The conducted and convected heat emitted by the appliance could be high enough to crack normal plaster. Use a high temperature plaster or face the area with a suitable non-combustible board, avoiding any joints above the appliance. New plaster should be fully dried before the appliance is used, or cracking could occur.

If you are in any doubt about your ability to produce a safe opening contact your Stovax dealer for professional advice.

FIRE SURROUND CLEARANCES

We recommend you obtain expert advice before proceeding with work of this nature.

Some finishes may discolour with heat and some lower quality products may distort, or crack, when in use.

If stone / granite / marble or any other natural material is used to construct the fire surround, or any part of it, provision should be made for expansion and movement of the parts due to heating and cooling.

If you are in any doubt about the installation requirements, or suitability of fire surrounds contact your Stovax dealer.

All fire surrounds should be suitable for use with solid fuel heating products.

SPARE PARTS

Atlas 2 shown

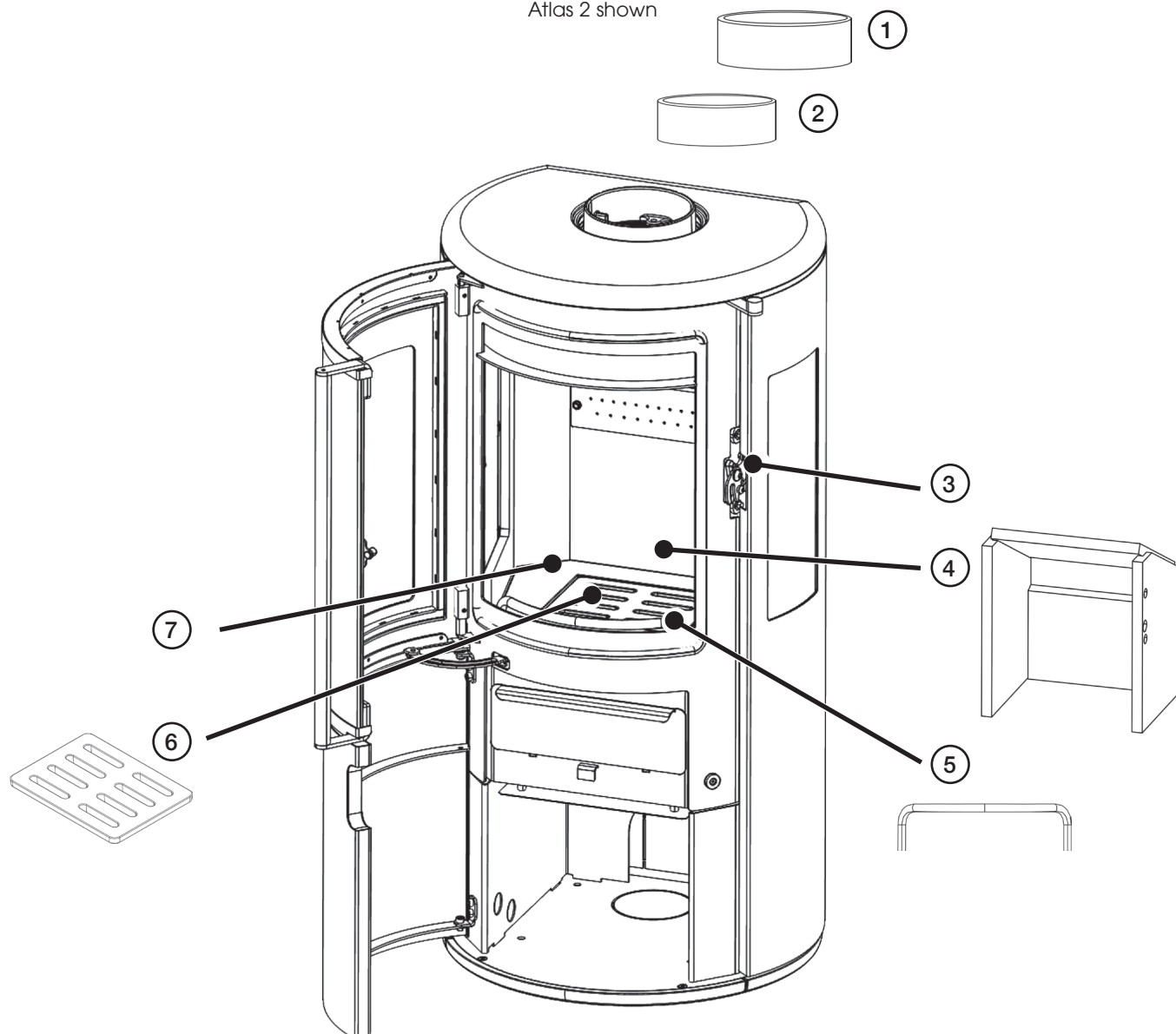

REF.	DESCRIPTION	ATLAS 1	ATLAS 2	ATLAS 3
1	Flue Adaptor	VD-R1	VD-R1	VD-R1
2	Flue Collar	CA8042	CA8042	CA8042
3	Door Catch Assembly	MEC12199	MEC12199	MEC12199
4	Brick Set	MEC12197	MEC12198	MEC12198
5	Fuel Retainer	RA505264	RA505264	RA505264
6	Grate Assembly	CA8041	CA8041	CA8041
7	Ash Pan Rope Seal	CE8653	CE8653	CE8653



Due to continual technical improvements please check online or with your Stovax retailer for the most up to date parts lists.

Only use Genuine Stovax spares when servicing your appliance.

All of our essential spare parts and consumable items are available to purchase from our webshop at www.stovaxspares.com.

DOOR

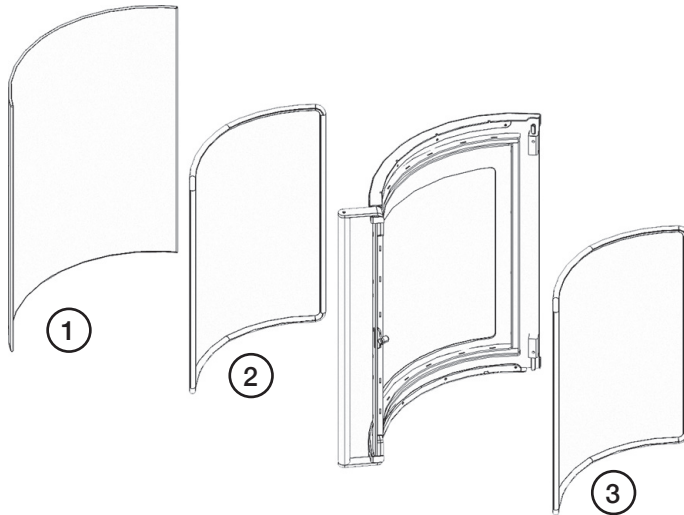

REF.	DESCRIPTION	
1	Front Glass	CE8645
2	Front Glass Rope Seal	CE8650
3	Door Rope	CE8654

SIDE WINDOW

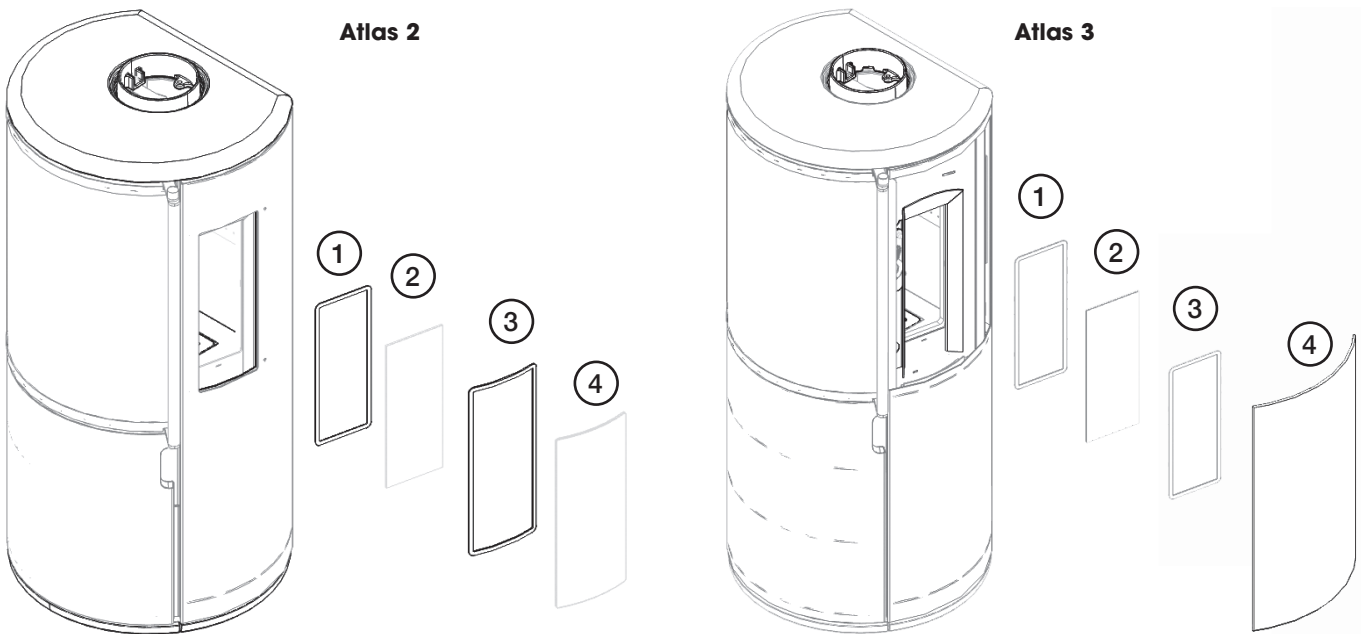

REF.	DESCRIPTION	ATLAS 2	ATLAS 3
1	Internal Side Glass Rope Seal	CE8652	CE8652
2	Internal Side Glass	CE8647	CE8647
3	External Side Glass Rope Seal	CE8651	CE8651
4	External Glass	CE8646	Left: CE8648 Right: CE8649

i Due to continual technical improvements please check online or with your Stovax retailer for the most up to date parts lists.

Only use Genuine Stovax spares when servicing your appliance.
All of our essential spare parts and consumable items are available to purchase from our webshop at www.stovaxspares.com.

PRODUCT FICHE - INFORMATION REQUIREMENT FOR WOOD LOCAL SPACE HEATER

Model	Atlas 1	Atlas 2	Atlas 3
Energy Efficiency Class	A+	A+	A+
Direct Heat Output (kW)	5kW	6.2kW	6.2kW
Indirect Output (kW)	n/a	n/a	n/a
Energy Efficiency Index (EEI)	107	109	109
Useful Energy Efficiency at Nominal Heat Output	81.0	82.0	82.0
Safety Precautions	Appliance must be installed, used and maintained in accordance with the manufacturer's instructions supplied		

PRODUCT MATERIAL INFORMATION

The following substances, preparations or components should be disposed of or recovered separately from other WEEE in compliance with Article 4 of EU Council Directive 75/442/EEC.

Metal	Steel	Can be taken to a local recycling centre for reuse to reduce waste going to landfill.
	Cast iron	
Glass		Can be taken to a local recycling centre for reuse to reduce waste going to landfill.
Vermiculite linings		Non hazardous material. Vermiculite can be crushed up and used for plant bedding and ash used for composting or disposed of at a local recycling centre for reuse to reduce waste going to landfill.
Rope seals		Rope seals are made from Refractory Ceramic Fibre (RCF), a material which is commonly used for this application. Protective clothing is not required when handling these articles, but it is recommended to follow normal hygiene rules of not smoking, eating or drinking in the work area and always wash hands before eating or drinking. When servicing the appliance it is recommended that the replaced items are not broken up, but are sealed within heavy duty polythene bags and labelled as RCF waste. RCF waste is classed as stable, non-reactive hazardous waste and may be disposed of at a licensed landfill site.
Electrical components	(Fan kits, etc. if applicable)	Dispose of at a local recycling centre in accordance with the WEEE directive.

SERVICE RECORDS

1ST SERVICE

Date of Service:

Next Service Due:

Signed:

Dealer's Stamp/HETAS Registration Number

3RD SERVICE

Date of Service:

Next Service Due:

Signed:

Dealer's Stamp/HETAS Registration Number

5TH SERVICE

Date of Service:

Next Service Due:

Signed:

Dealer's Stamp/HETAS Registration Number

7TH SERVICE

Date of Service:

Next Service Due:

Signed:

Dealer's Stamp/HETAS Registration Number

9TH SERVICE

Date of Service:

Next Service Due:

Signed:

Dealer's Stamp/HETAS Registration Number

2ND SERVICE

Date of Service:

Next Service Due:

Signed:

Dealer's Stamp/HETAS Registration Number

4TH SERVICE

Date of Service:

Next Service Due:

Signed:

Dealer's Stamp/HETAS Registration Number

6TH SERVICE

Date of Service:

Next Service Due:

Signed:

Dealer's Stamp/HETAS Registration Number

8TH SERVICE

Date of Service:

Next Service Due:

Signed:

Dealer's Stamp/HETAS Registration Number

10TH SERVICE

Date of Service:

Next Service Due:

Signed:

Dealer's Stamp/HETAS Registration Number

FOR ENQUIRIES IN THE U.K (EXCLUDING NI):

Stovax Gazco Limited, Spitfire Avenue, Skypark, Clyst Honiton, Exeter, Devon, England EX5 2FR

Tel: (01392) 474011 E-mail: info@stovax.com www.stovax.com

FOR ENQUIRIES IN EUROPE (INCLUDING NI):

Stovax Heating Group (NI) Ltd (Comp reg NI675194), 40 Linenhall Street, Belfast, BT2 8BA

DX 400 NR Belfast Tel: +44 (0)1392 261990 E-mail: northernireland@stovax.com



STOVAX



PM2085